



Tonight's Meeting

- 6:30 to 7:00 PM Poster Session
 - Submit questions into the question box
- Hearing begins at 7:00 PM
 - Opportunity to give official testimony

Contact Information

Maryland Department of the Environment
Attn: Emily Dolbin
1800 Washington Boulevard
Baltimore, MD 21230
Emily.Dolbin@maryland.gov
(667) 219-3279



I-95 EXPRESS TOLL LANES (ETL) NORTHBOUND EXTENSION

I-95 ETL Northbound Extension Program

Phase I Permit Modification

Virtual Poster Session
March 4, 2021

mdta.maryland.gov/I95ETLNB/home.html

I95ETLNB@mdta.maryland.gov





Northbound I-95 Mainline Typical Sections

EXISTING

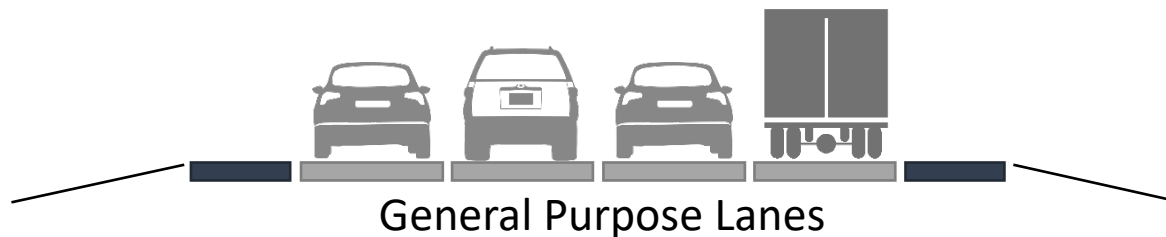

PROPOSED

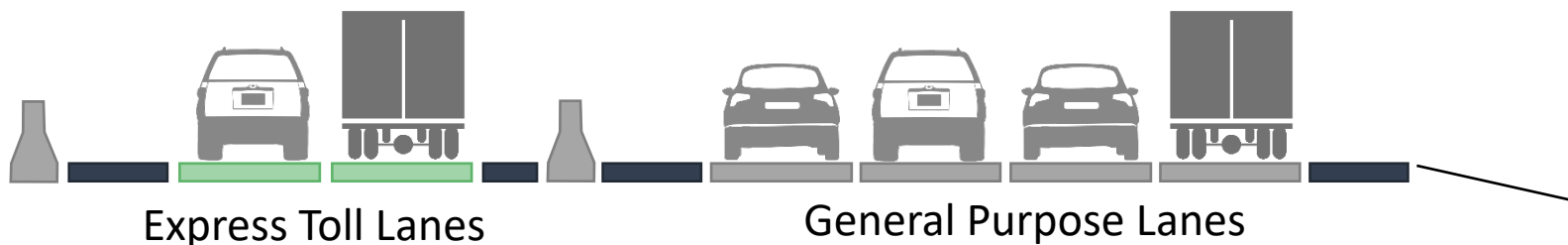



I-95 EXPRESS TOLL LANES (ETL) NORTHBOUND EXTENSION

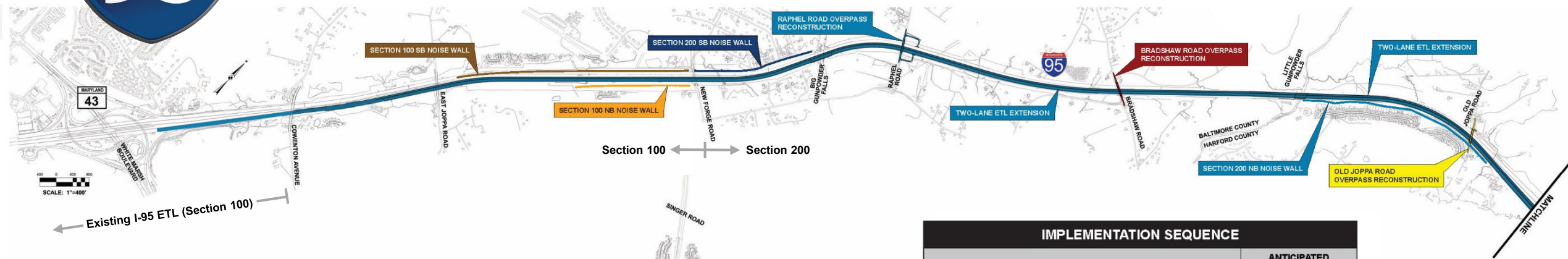

IMPLEMENTATION SEQUENCE		
CONTRACT		ANTICIPATED CONSTRUCTION SCHEDULE
PHASE I		
KH-3012	BRADSHAW ROAD OVERPASS RECONSTRUCTION	COMPLETED
KH-3013	SECTION 100 SB NOISE WALL	COMPLETED
KH-3016	SECTION 100 NB NOISE WALL	COMPLETED
KH-3009	I-95 NB TWO-LANE ETL EXTENSION TO MD 152 RAPHÉL ROAD OVERPASS RECONSTRUCTION SECTION 200 NB NOISE WALL	SPRING 2021 – SUMMER 2024
KH-3015	OLD JOPPA ROAD OVERPASS RECONSTRUCTION	COMPLETED
KH-3010	I-95 NB AUXILIARY LANE MD 152 TO MD 24 MODIFY MD 24/MD 924 RAMP	SPRING 2019 – SUMMER 2021
KH-3014	SECTION 200 SB NOISE WALL	WINTER 2020/21 – SPRING 2022





I-95 EXPRESS TOLL LANES (ETL) NORTHBOUND EXTENSION

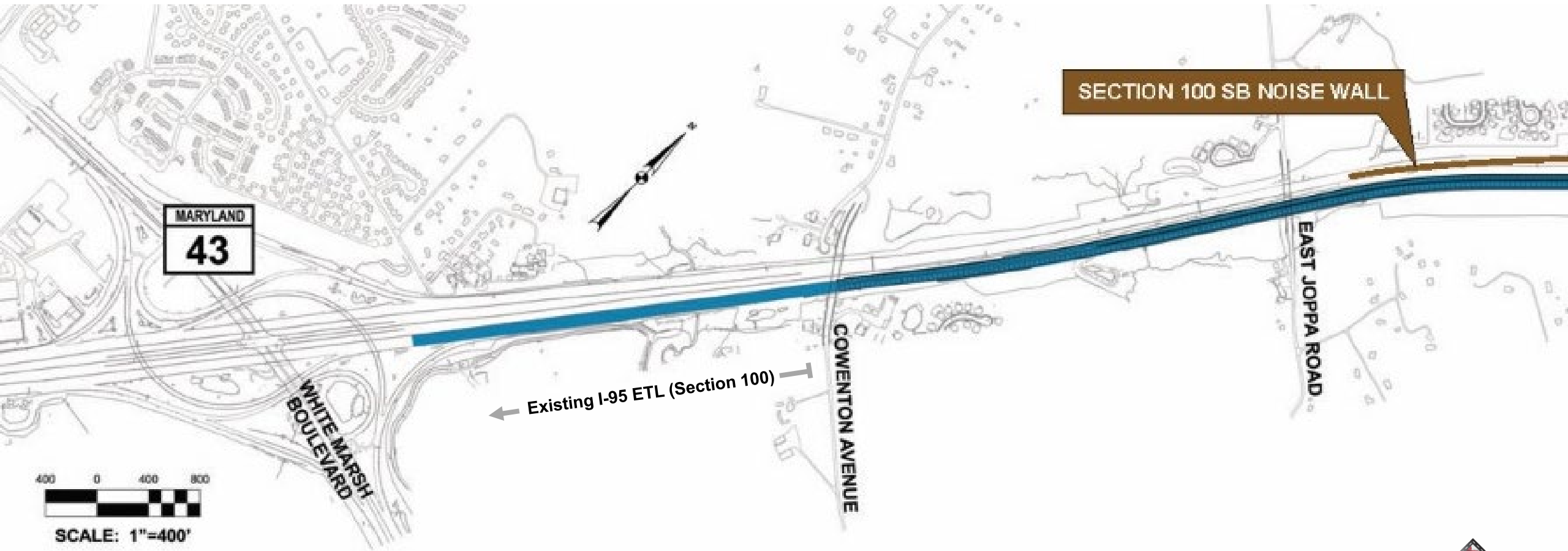



I-95 EXPRESS TOLL LANES (ETL) NORTHBOUND EXTENSION

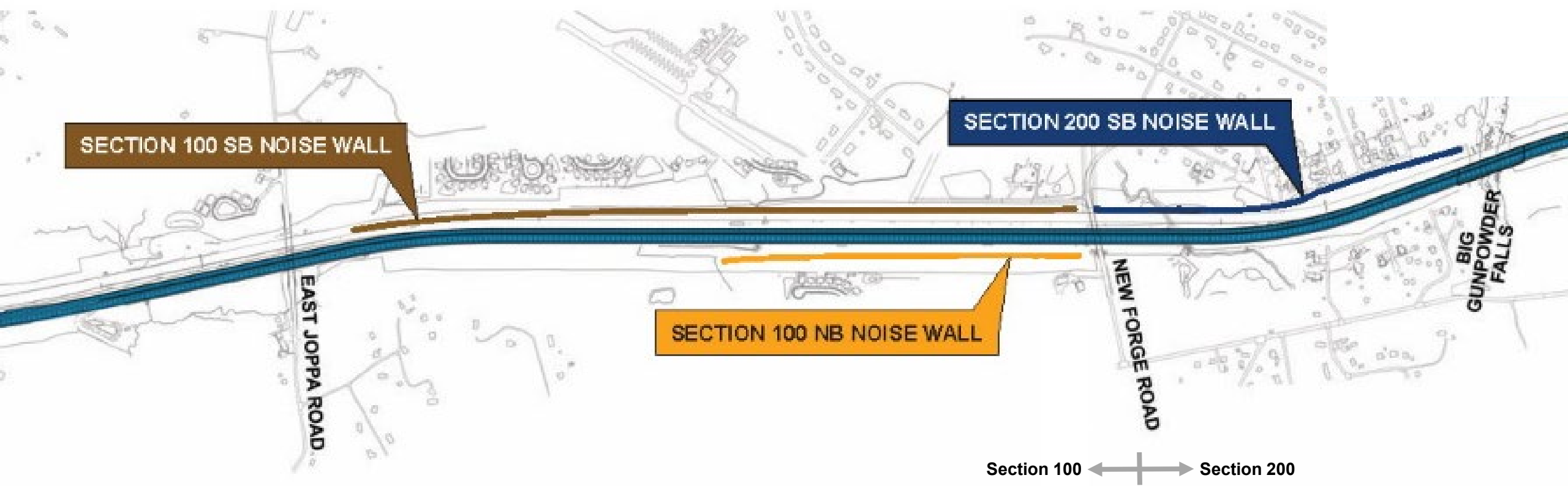



I-95 EXPRESS TOLL LANES (ETL) NORTHBOUND EXTENSION

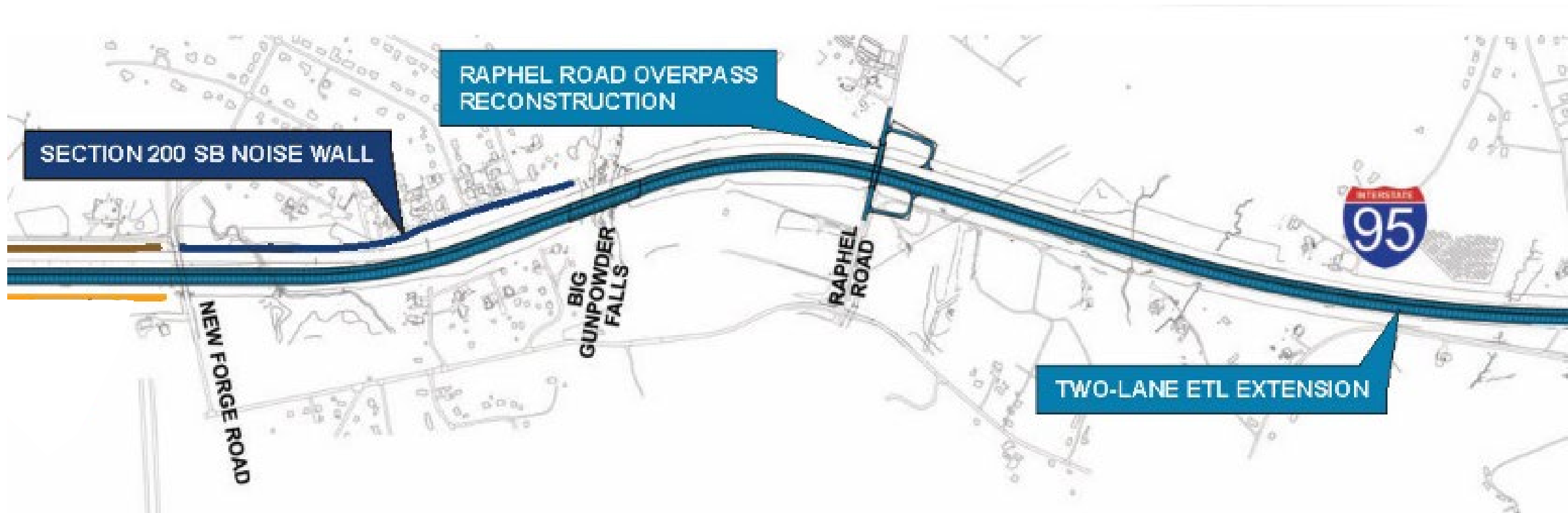



I-95 EXPRESS TOLL LANES (ETL) NORTHBOUND EXTENSION

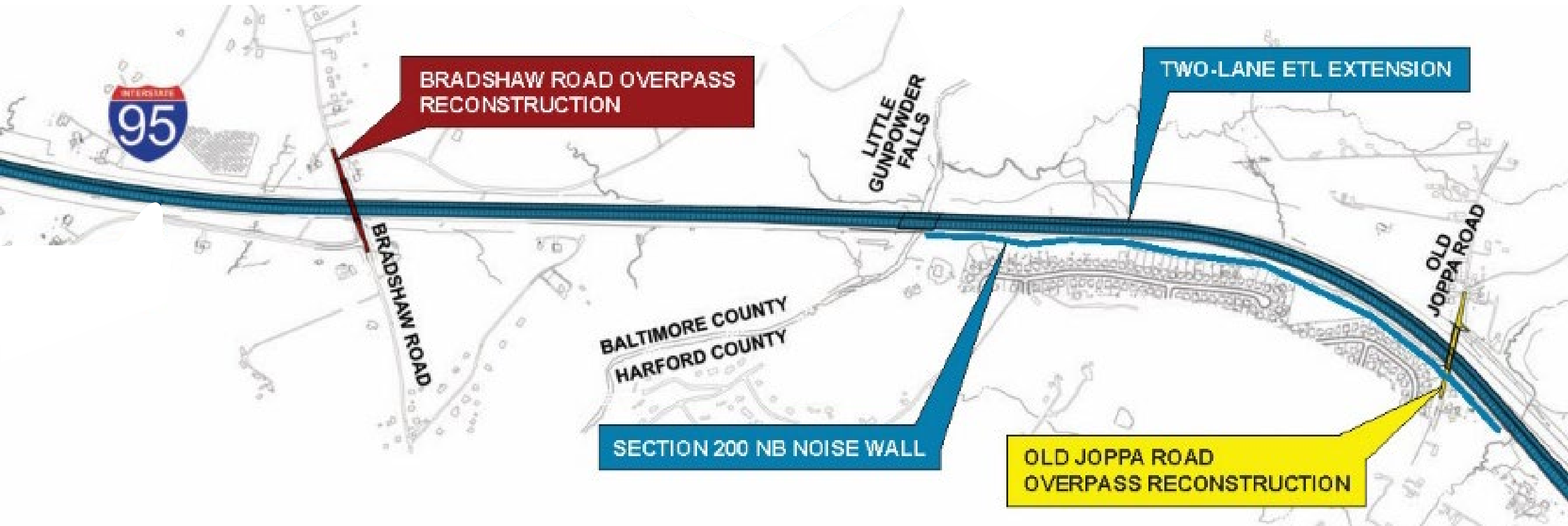



I-95 EXPRESS TOLL LANES (ETL) NORTHBOUND EXTENSION

