

LAKESIDE AT TRAPPE WETLANDS IMPACTS PERMIT DRAWINGS

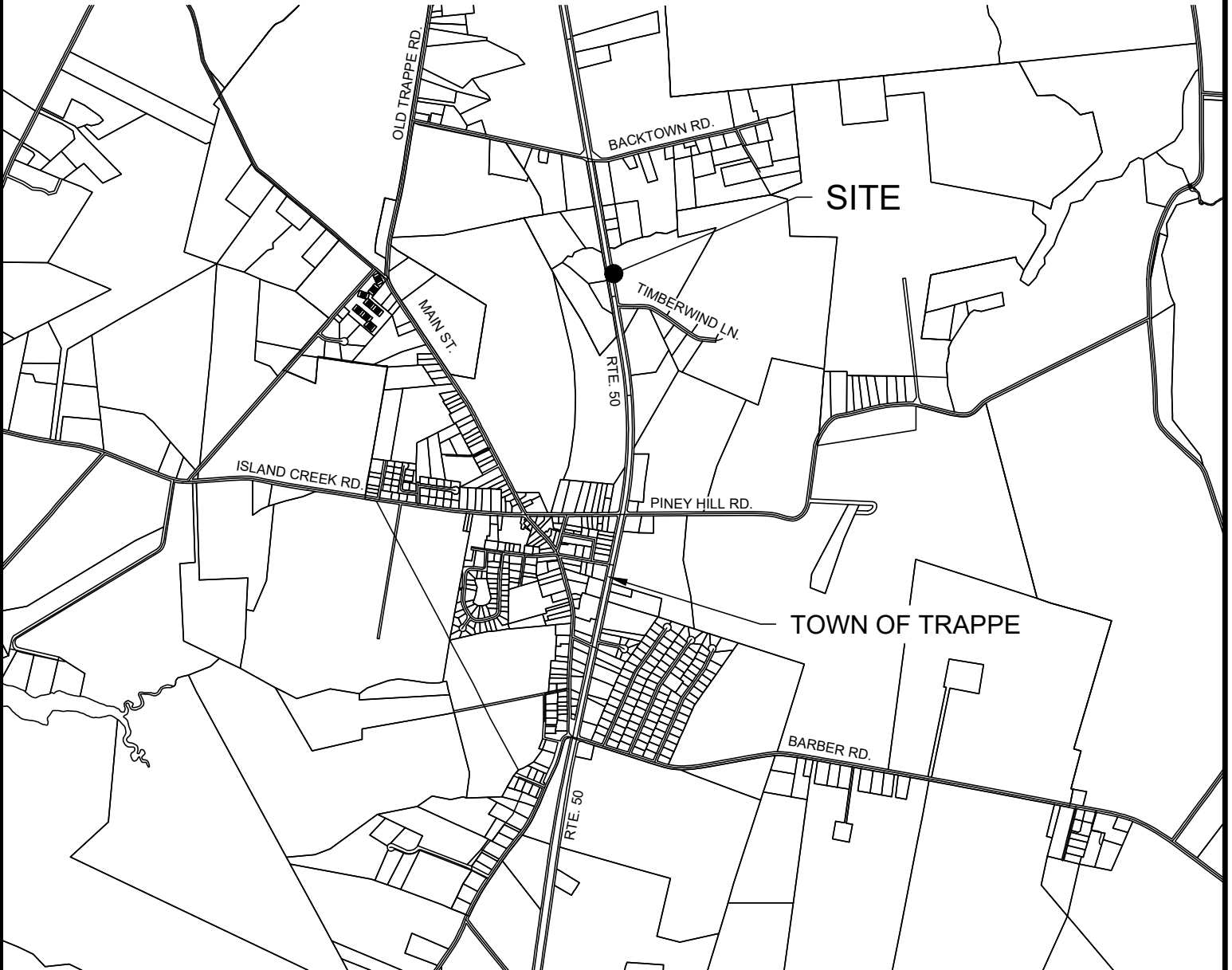
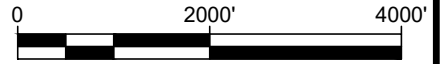

VICINITY MAP
SCALE: 1" = 2000'

SITE VICINITY MAP

ON THE LANDS OF:

TRAPPE EAST BUSINESS HOLDINGS TRUST

TAX MAP 55, GRID 13, PARCEL 4,14,15,17,19,44,65,83

THIRD ELECTION DISTRICT, TALBOT COUNTY, MARYLAND

DRAWN BY KAK

SCALE 1" = 2000'

DATE 04.16.21

SHEET 1 OF 22

RAUCH

inc.

engineering design &
development services

office: 410.770.9081 | fax: 410.770.3667

email: design@raucheng.com | web: www.raucheng.com

Maryland Office: 106 N. Harrison St - Easton, MD 21601

Virginia Office: 8229 Boone Blvd, Suite 625 - Vienna, VA 22182

WRIGHT'S ADVENTURE
(FOX HALL FARM) T-384 OF
MHT HISTORICAL SITES

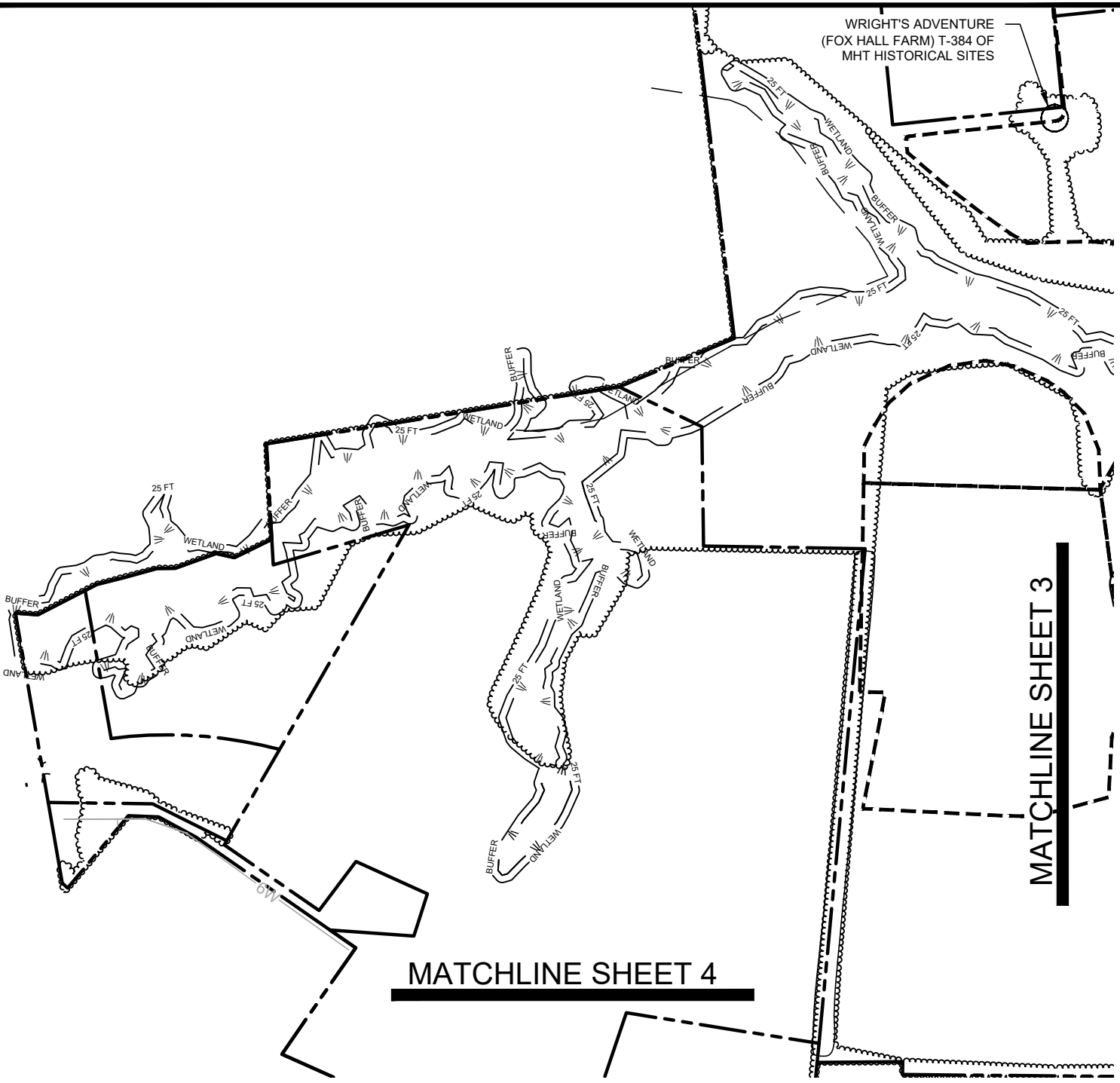

LEGEND:

- \ / — = NONTIDAL WETLANDS
- 25 FT — WETLAND — BUFFER —
- (wavy line) — = EXISTING TREELINE
- (dashed line) — = PROPERTY LINE

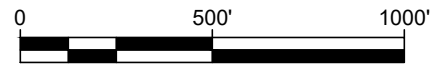

EXISTING CONDITIONS

ON THE LANDS OF:

TRAPPE EAST BUSINESS HOLDINGS TRUST

TAX MAP 55, GRID 13, PARCEL 4,14,15,17,19,44,65,83

THIRD ELECTION DISTRICT, TALBOT COUNTY, MARYLAND

DRAWN BY KAK

SCALE 1" = 500'

DATE 04.16.21

SHEET 2 OF 22



RAUCH
inc.

engineering design &
development services

office: 410.770.9081 | fax: 410.770.3667
email: design@raucheng.com | web: www.raucheng.com
Maryland Office: 106 N. Harrison St - Easton, MD 21601
Virginia Office: 8229 Boone Blvd, Suite 625 - Vienna, VA 22182

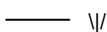
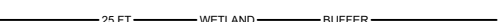

LEGEND:

-  = NONTIDAL WETLANDS
-  = 25 FT WETLAND BUFFER
-  = EXISTING TREELINE
-  = PROPERTY LINE

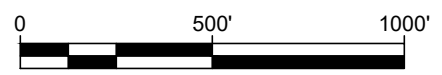

EXISTING CONDITIONS

ON THE LANDS OF:

TRAPPE EAST BUSINESS HOLDINGS TRUST

TAX MAP 55, GRID 13, PARCEL 4,14,15,17,19,44,65,83

THIRD ELECTION DISTRICT, TALBOT COUNTY, MARYLAND

DRAWN BY KAK

SCALE 1" = 500'

DATE 04.16.21

SHEET 3 OF 22

RAUCH

inc.

engineering design &
development services

office: 410.770.9081 | fax: 410.770.3667
 email: design@raucheng.com | web: www.raucheng.com
 Maryland Office: 106 N. Harrison St - Easton, MD 21601
 Virginia Office: 8229 Boone Blvd, Suite 625 - Vienna, VA 22182

EXISTING GRAVESITE NOT INDEXED ON MHT AS A HISTORICAL SITE

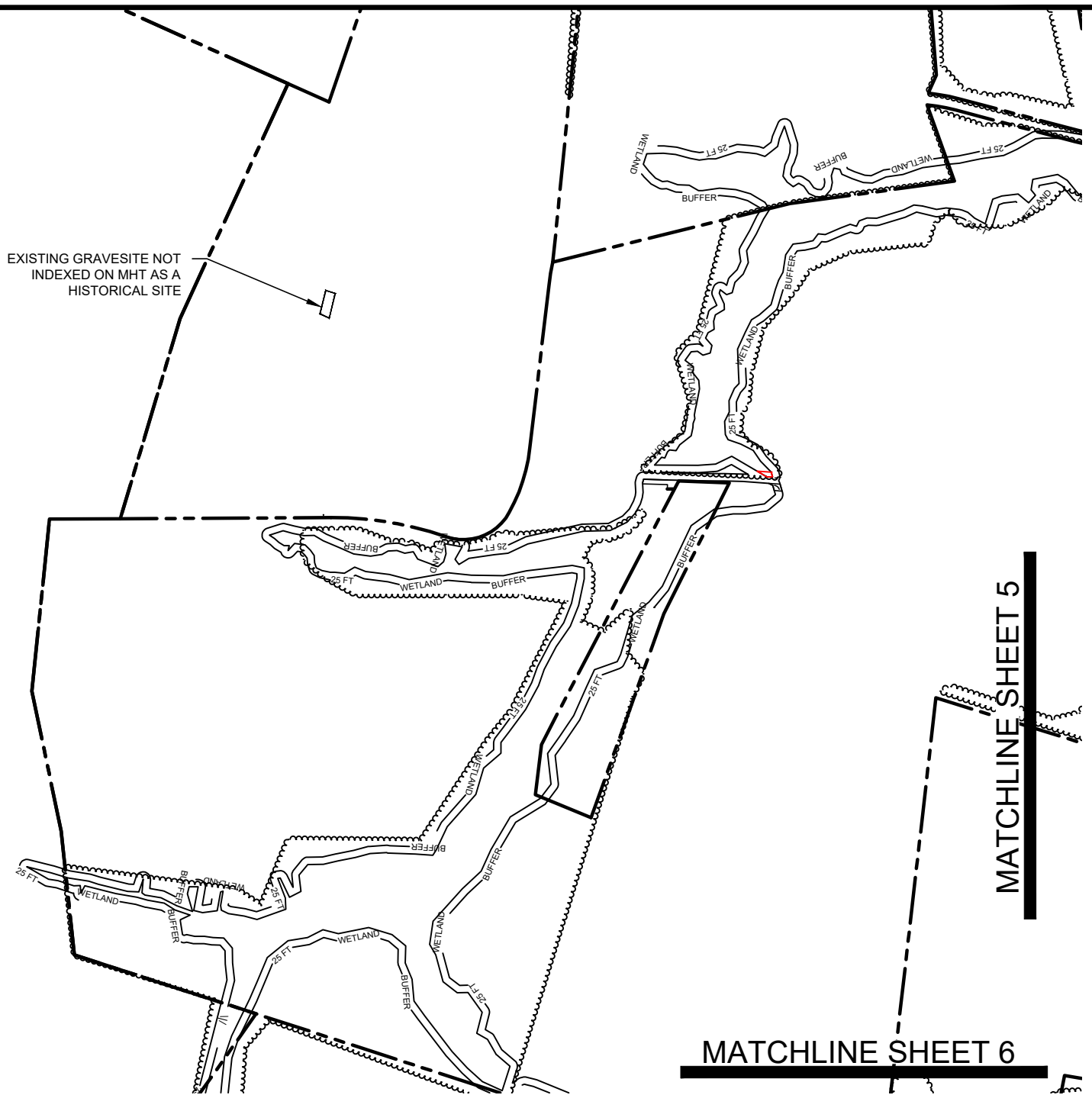

LEGEND:

- = NONTIDAL WETLANDS
- = 25 FT WETLAND BUFFER
- = EXISTING TREELINE
- = PROPERTY LINE

MATCHLINE SHEET 6

MATCHLINE SHEET 5



EXISTING CONDITIONS

ON THE LANDS OF:

TRAPPE EAST BUSINESS HOLDINGS TRUST

TAX MAP 55, GRID 13, PARCEL 4,14,15,17,19,44,65,83

THIRD ELECTION DISTRICT, TALBOT COUNTY, MARYLAND

DRAWN BY KAK

SCALE 1" = 500'

DATE 04.16.21

SHEET 4 OF 22

RAUCH
inc.

engineering design &
development services

office: 410.770.9081 | fax: 410.770.3667
email: design@raucheng.com | web: www.raucheng.com
Maryland Office: 106 N. Harrison St - Easton, MD 21601
Virginia Office: 8229 Boone Blvd, Suite 625 - Vienna, VA 22182

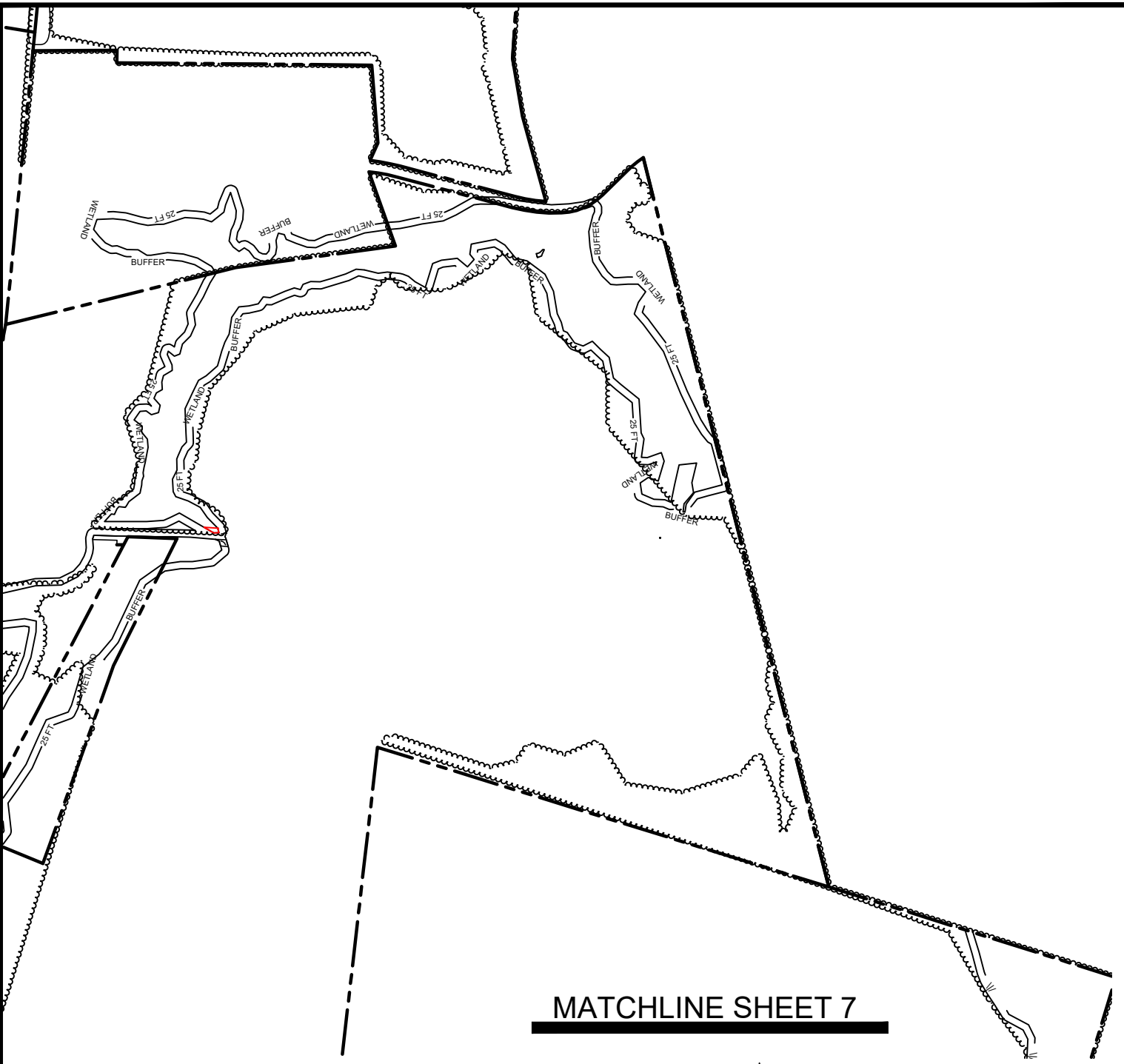

MATCHLINE SHEET 7

LEGEND:

- \| — \| — = NONTIDAL WETLANDS
- 25 FT — WETLAND — BUFFER —
- ~ ~ ~ — = EXISTING TREELINE
- - - - - = PROPERTY LINE

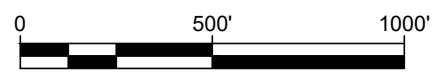

EXISTING CONDITIONS
ON THE LANDS OF:
TRAPPE EAST BUSINESS HOLDINGS TRUST
TAX MAP 55, GRID 13, PARCEL 4,14,15,17,19,44,65,83
THIRD ELECTION DISTRICT, TALBOT COUNTY, MARYLAND

DRAWN BY	KAK
SCALE	1" = 500'
DATE	04.16.21
SHEET	5 OF 22

RAUCH
inc.
engineering design & development services

office: 410.770.9081 | fax: 410.770.3667
email: design@raucheng.com | web: www.raucheng.com
Maryland Office: 106 N. Harrison St - Easton, MD 21601
Virginia Office: 8229 Boone Blvd, Suite 625 - Vienna, VA 22182

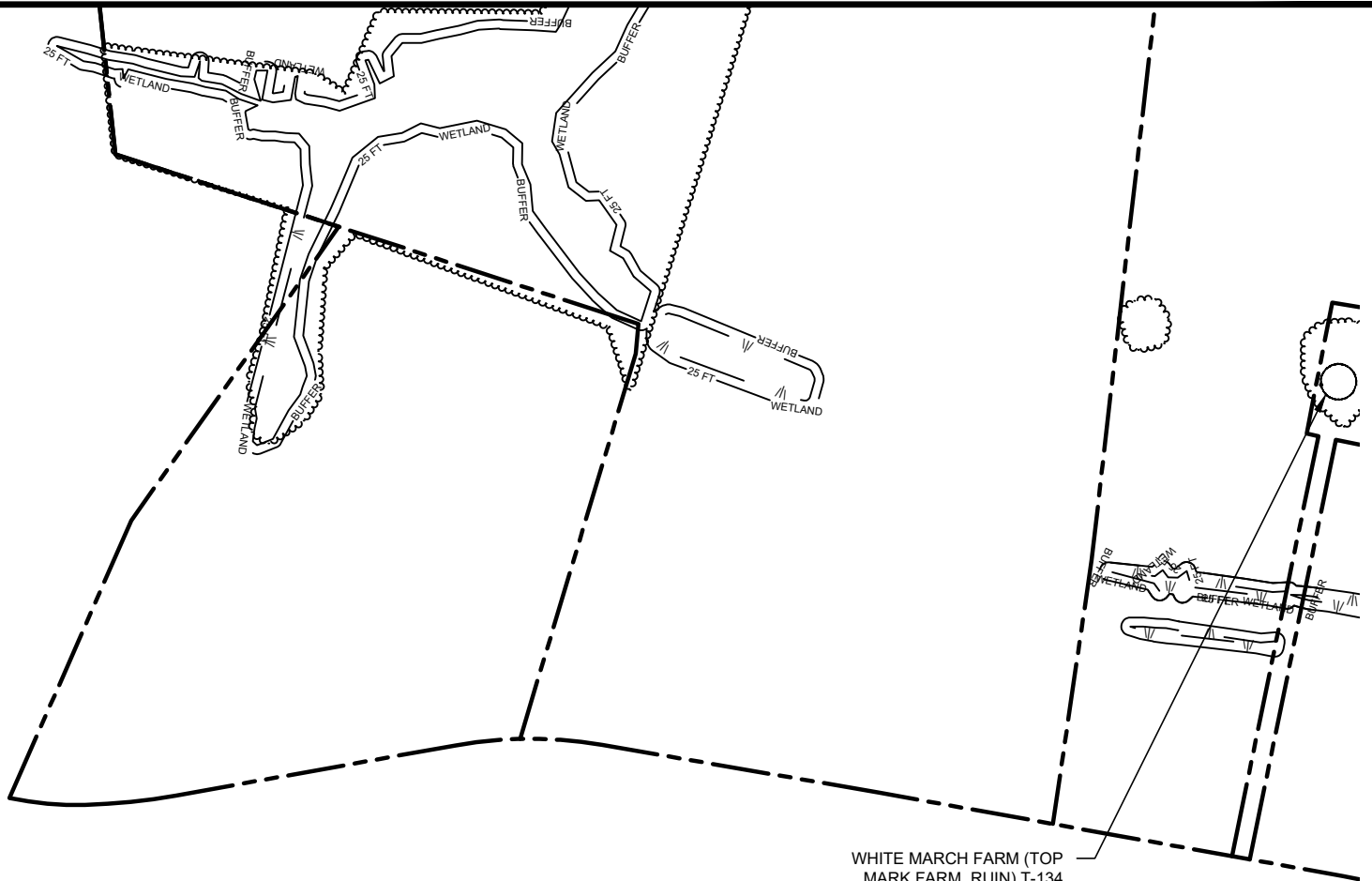

WHITE MARCH FARM (TOP MARK FARM, RUIN) T-134 OF MHT HISTORICAL SITES

MATCHLINE SHEET 7

LEGEND:

- = NONTIDAL WETLANDS
- = 25 FT WETLAND BUFFER
- = EXISTING TREELINE
- = PROPERTY LINE

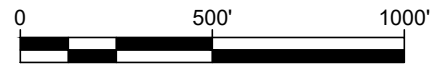

EXISTING CONDITIONS

ON THE LANDS OF:

TRAPPE EAST BUSINESS HOLDINGS TRUST

TAX MAP 55, GRID 13, PARCEL 4,14,15,17,19,44,65,83

THIRD ELECTION DISTRICT, TALBOT COUNTY, MARYLAND

DRAWN BY KAK

SCALE 1" = 500'

DATE 04.16.21

SHEET 6 OF 22

RAUCH

inc.

engineering design & development services

office: 410.770.9081 | fax: 410.770.3667
 email: design@raucheng.com | web: www.raucheng.com
 Maryland Office: 106 N. Harrison St - Easton, MD 21601
 Virginia Office: 8229 Boone Blvd, Suite 625 - Vienna, VA 22182

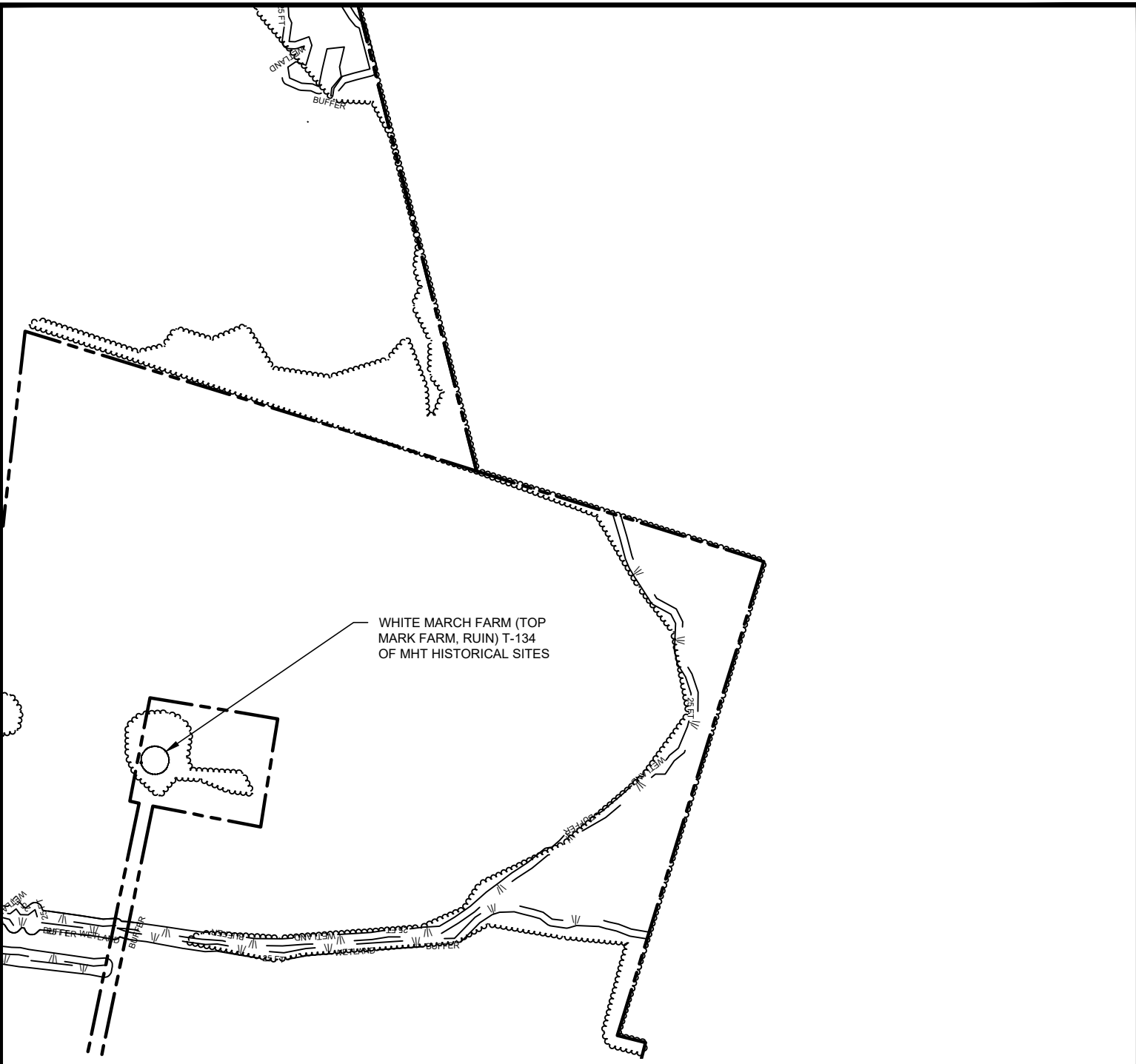

LEGEND:

- \| — \| — = NONTIDAL WETLANDS
- 25 FT WETLAND BUFFER — = 25 FT WETLAND BUFFER
- ~ — = EXISTING TREELINE
- - - - - = PROPERTY LINE

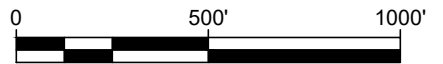

EXISTING CONDITIONS

ON THE LANDS OF:

TRAPPE EAST BUSINESS HOLDINGS TRUST

TAX MAP 55, GRID 13, PARCEL 4,14,15,17,19,44,65,83

THIRD ELECTION DISTRICT, TALBOT COUNTY, MARYLAND

DRAWN BY KAK

SCALE 1" = 2000'

DATE 04.16.21

SHEET 7 OF 22

RAUCH
inc.
engineering design &
development services

office: 410.770.9081 | fax: 410.770.3667
email: design@raucheng.com | web: www.raucheng.com
Maryland Office: 106 N. Harrison St - Easton, MD 21601
Virginia Office: 8229 Boone Blvd, Suite 625 - Vienna, VA 22182

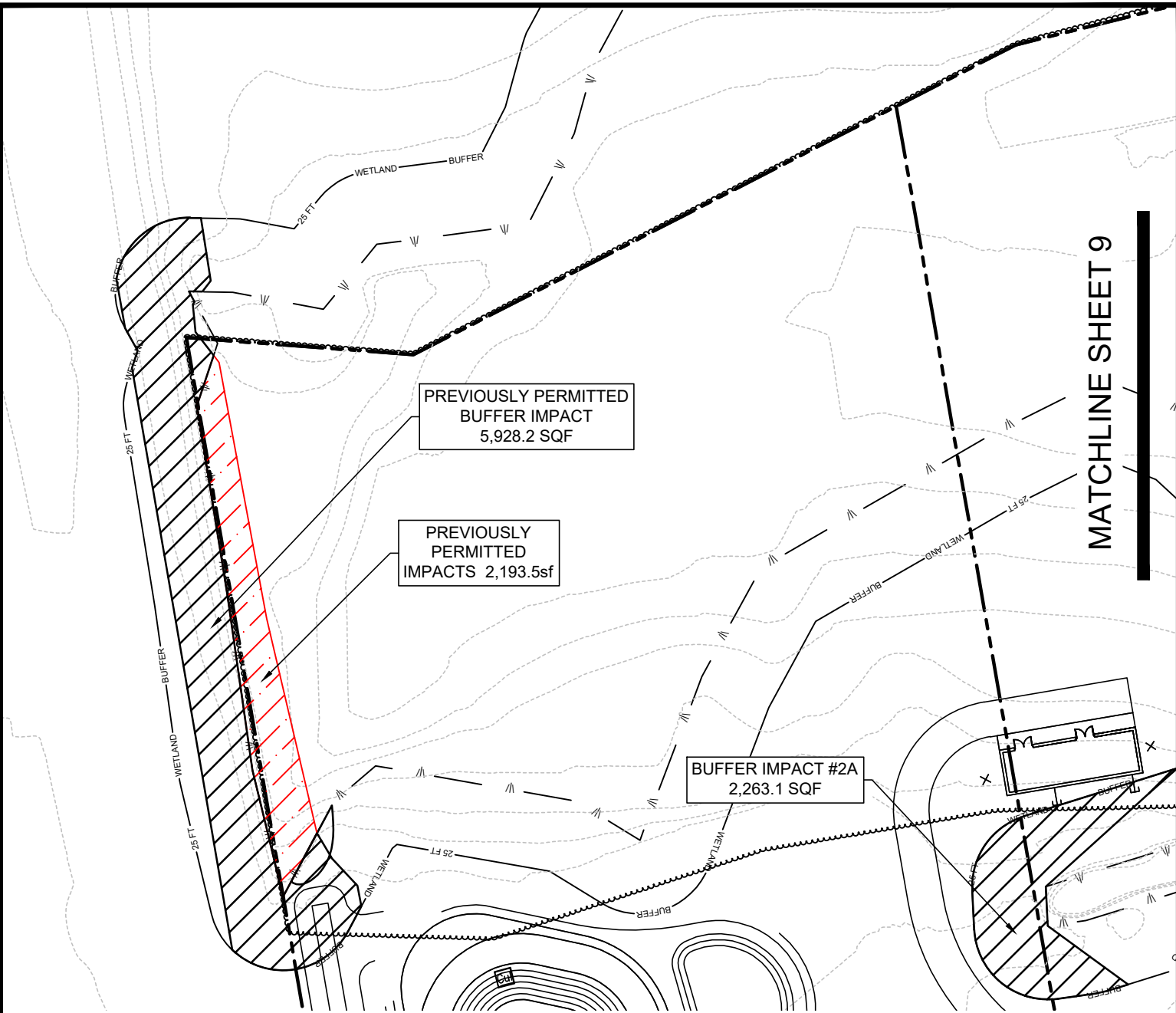

LEGEND:

- = NONTIDAL WETLANDS
- = 25 FT WETLAND BUFFER
- = EXISTING TREELINE
- = PROPERTY LINE
- = LIMITS OF DISTURBANCE
- = WETLANDS IMPACT
- = WETLANDS BUFFER IMPACT

PROPOSED IMPACTS
ON THE LANDS OF:
TRAPPE EAST BUSINESS HOLDINGS TRUST
TAX MAP 55, GRID 13, PARCEL 4,14,15,17,19,44,65,83
THIRD ELECTION DISTRICT, TALBOT COUNTY, MARYLAND

DRAWN BY	KAK
SCALE	1" = 50'
DATE	04.16.21
SHEET	8 OF 22

RAUCH

inc.

engineering design & development services

office: 410.770.9081 | fax: 410.770.3667
email: design@raucheng.com | web: www.raucheng.com
Maryland Office: 106 N. Harrison St - Easton, MD 21601
Virginia Office: 8229 Boone Blvd, Suite 625 - Vienna, VA 22182

MATCHLINE SHEET 10

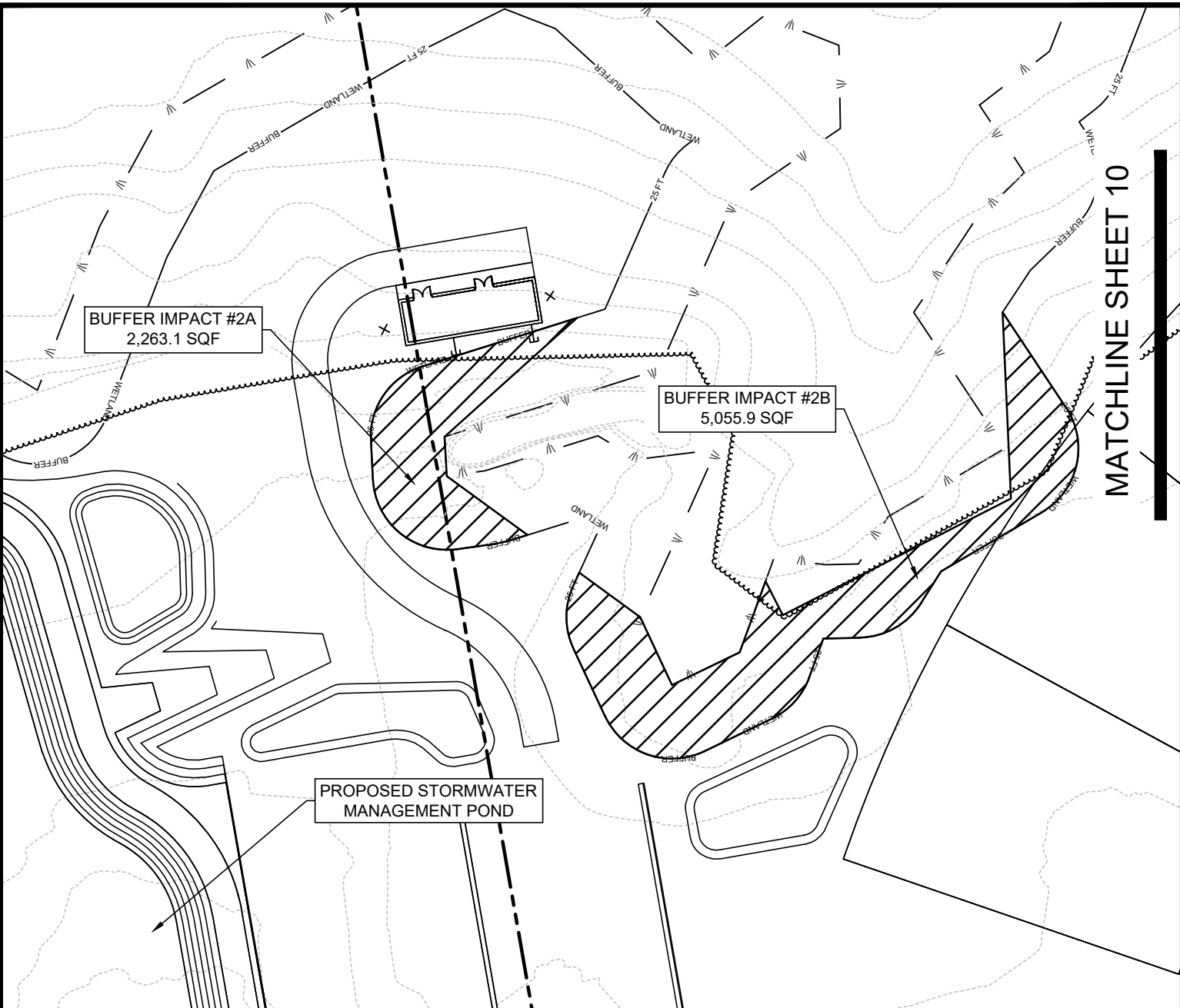

LEGEND:

- = NONTIDAL WETLANDS
- = 25 FT WETLAND BUFFER
- = EXISTING TREELINE
- = PROPERTY LINE
- = LIMITS OF DISTURBANCE
- = WETLANDS IMPACT
- = WETLANDS BUFFER IMPACT

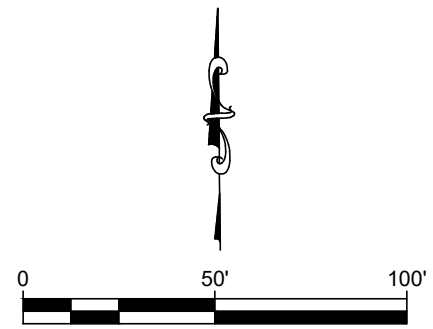

PROPOSED IMPACTS	
ON THE LANDS OF:	
TRAPPE EAST BUSINESS HOLDINGS TRUST	
TAX MAP 55, GRID 13, PARCEL 4,14,15,17,19,44,65,83	
THIRD ELECTION DISTRICT, TALBOT COUNTY, MARYLAND	

DRAWN BY	KAK
SCALE	1" = 50'
DATE	04.16.21
SHEET	9 OF 22

RAUCH
inc.

engineering design &
development services

office: 410.770.9081 | fax: 410.770.3667
 email: design@raucheng.com | web: www.raucheng.com
 Maryland Office: 106 N. Harrison St - Easton, MD 21601
 Virginia Office: 8229 Boone Blvd, Suite 625 - Vienna, VA 22182



BUFFER IMPACT #2C
4,004.3 SQF

BUFFER IMPACT #2D
1,916.7 SQF

LEGEND:

- = NONTIDAL WETLANDS
- = 25 FT WETLAND BUFFER
- = EXISTING TREELINE
- = PROPERTY LINE
- = LIMITS OF DISTURBANCE
- = WETLANDS IMPACT
- = WETLANDS BUFFER IMPACT

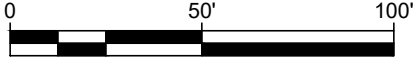

PROPOSED IMPACTS	
ON THE LANDS OF:	
TRAPPE EAST BUSINESS HOLDINGS TRUST	
TAX MAP 55, GRID 13, PARCEL 4,14,15,17,19,44,65,83	
THIRD ELECTION DISTRICT, TALBOT COUNTY, MARYLAND	

DRAWN BY	KAK
SCALE	1" = 50'
DATE	04.16.21
SHEET	10 OF 22

RAUCH
inc.
engineering design & development services

office: 410.770.9081 | fax: 410.770.3667
email: design@raucheng.com | web: www.raucheng.com
Maryland Office: 106 N. Harrison St - Easton, MD 21601
Virginia Office: 8229 Boone Blvd, Suite 625 - Vienna, VA 22182

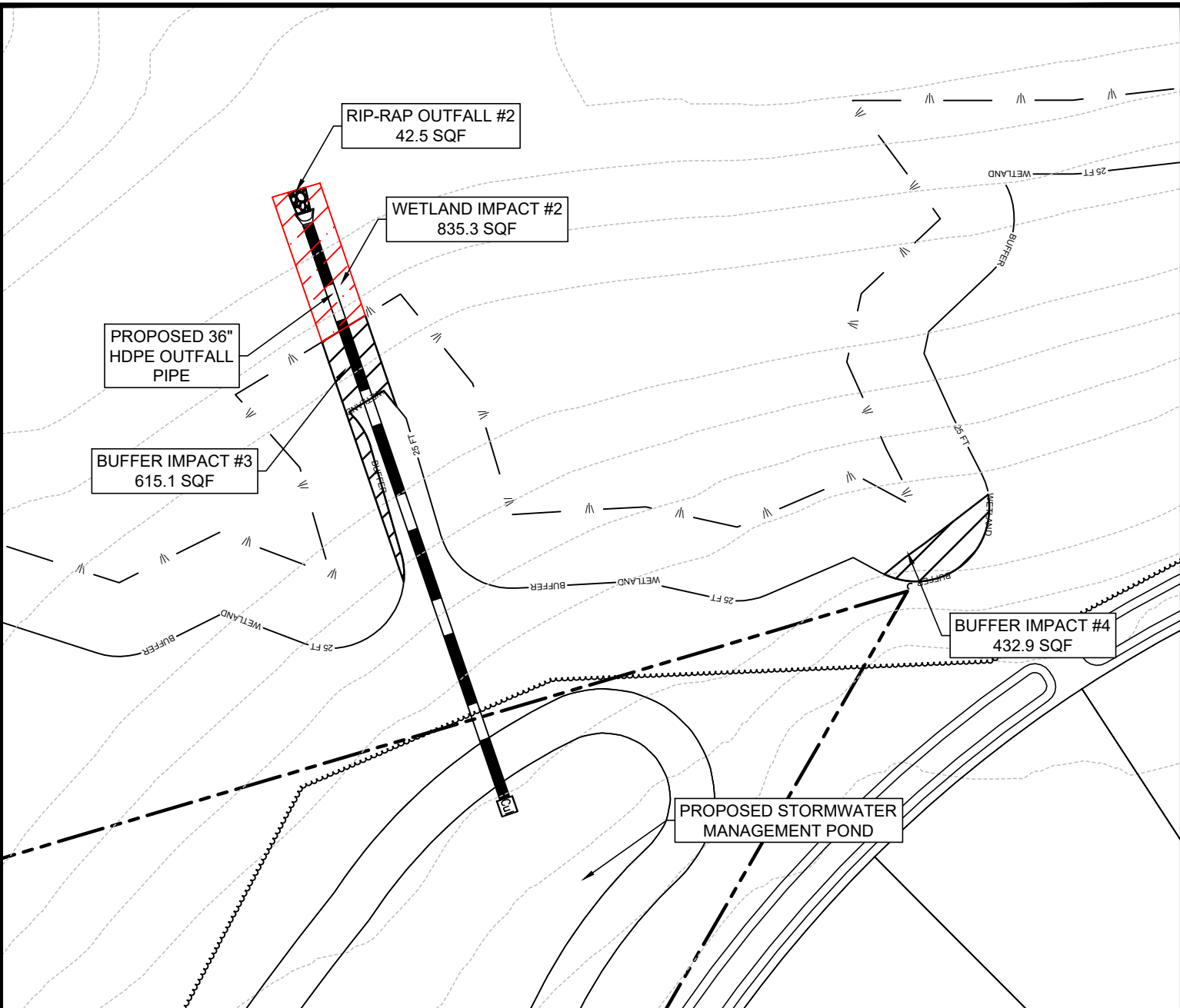

LEGEND:

- = NONTIDAL WETLANDS
- = 25 FT WETLAND BUFFER
- = EXISTING TREELINE
- = PROPERTY LINE
- = LIMITS OF DISTURBANCE
- = WETLANDS IMPACT
- = WETLANDS BUFFER IMPACT

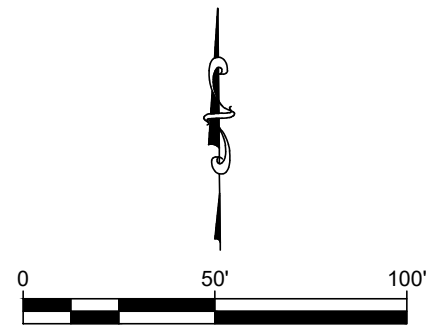

PROPOSED IMPACTS
ON THE LANDS OF:
TRAPPE EAST BUSINESS HOLDINGS TRUST
TAX MAP 55, GRID 13, PARCEL 4,14,15,17,19,44,65,83
THIRD ELECTION DISTRICT, TALBOT COUNTY, MARYLAND

DRAWN BY	KAK
SCALE	1" = 50'
DATE	04.16.21
SHEET	11 OF 22

RAUCH
inc.

engineering design & development services

office: 410.770.9081 | fax: 410.770.3667
email: design@raucheng.com | web: www.raucheng.com
Maryland Office: 106 N. Harrison St - Easton, MD 21601
Virginia Office: 8229 Boone Blvd, Suite 625 - Vienna, VA 22182

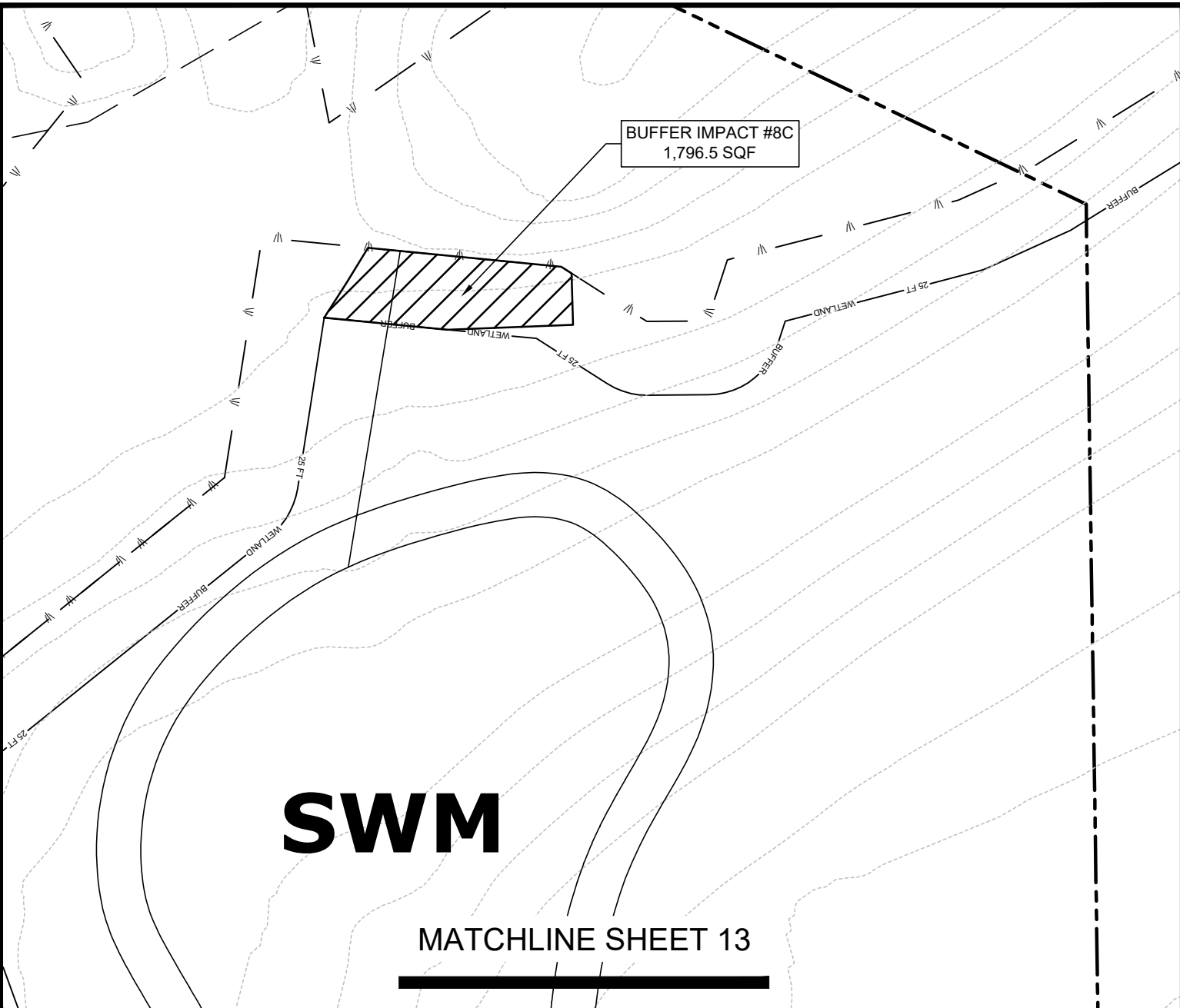

LEGEND:

- = NONTIDAL WETLANDS
- = 25 FT WETLAND BUFFER
- = EXISTING TREELINE
- = PROPERTY LINE
- = LIMITS OF DISTUBANCE
- = WETLANDS IMPACT
- = WETLANDS BUFFER IMPACT

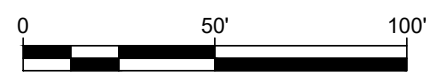

PROPOSED IMPACTS
ON THE LANDS OF:
TRAPPE EAST BUSINESS HOLDINGS TRUST
TAX MAP 55, GRID 13, PARCEL 4,14,15,17,19,44,65,83
THIRD ELECTION DISTRICT, TALBOT COUNTY, MARYLAND

DRAWN BY	KAK
SCALE	1" = 50'
DATE	04.16.21
SHEET	12 OF 22

RAUCH
inc.

engineering design &
development services

office: 410.770.9081 | fax: 410.770.3667
email: design@raucheng.com | web: www.raucheng.com
Maryland Office: 106 N. Harrison St - Easton, MD 21601
Virginia Office: 8229 Boone Blvd, Suite 625 - Vienna, VA 22182

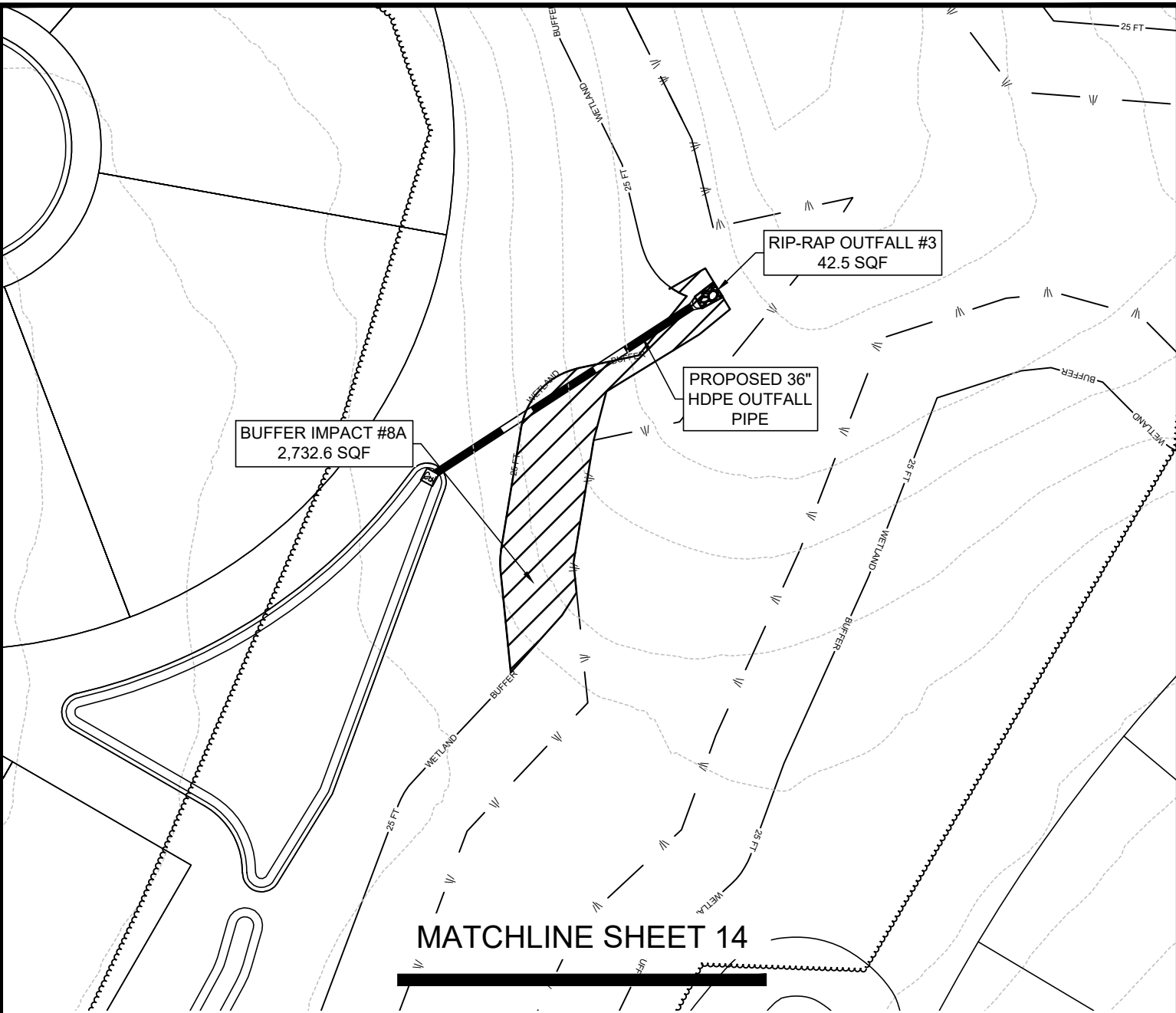

LEGEND:

- = NONTIDAL WETLANDS
- = 25 FT WETLAND BUFFER
- = EXISTING TREELINE
- = PROPERTY LINE
- = LOD = LIMITS OF DISTURBANCE
- = WETLANDS IMPACT
- = WETLANDS BUFFER IMPACT

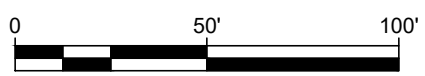

PROPOSED IMPACTS	
ON THE LANDS OF:	
TRAPPE EAST BUSINESS HOLDINGS TRUST	
TAX MAP 55, GRID 13, PARCEL 4,14,15,17,19,44,65,83	
THIRD ELECTION DISTRICT, TALBOT COUNTY, MARYLAND	

DRAWN BY	KAK
SCALE	1" = 50'
DATE	04.16.21
SHEET	13 OF 22

RAUCH
inc.

engineering design &
development services

office: 410.770.9081 | fax: 410.770.3667
 email: design@raucheng.com | web: www.raucheng.com
 Maryland Office: 106 N. Harrison St - Easton, MD 21601
 Virginia Office: 8229 Boone Blvd, Suite 625 - Vienna, VA 22182

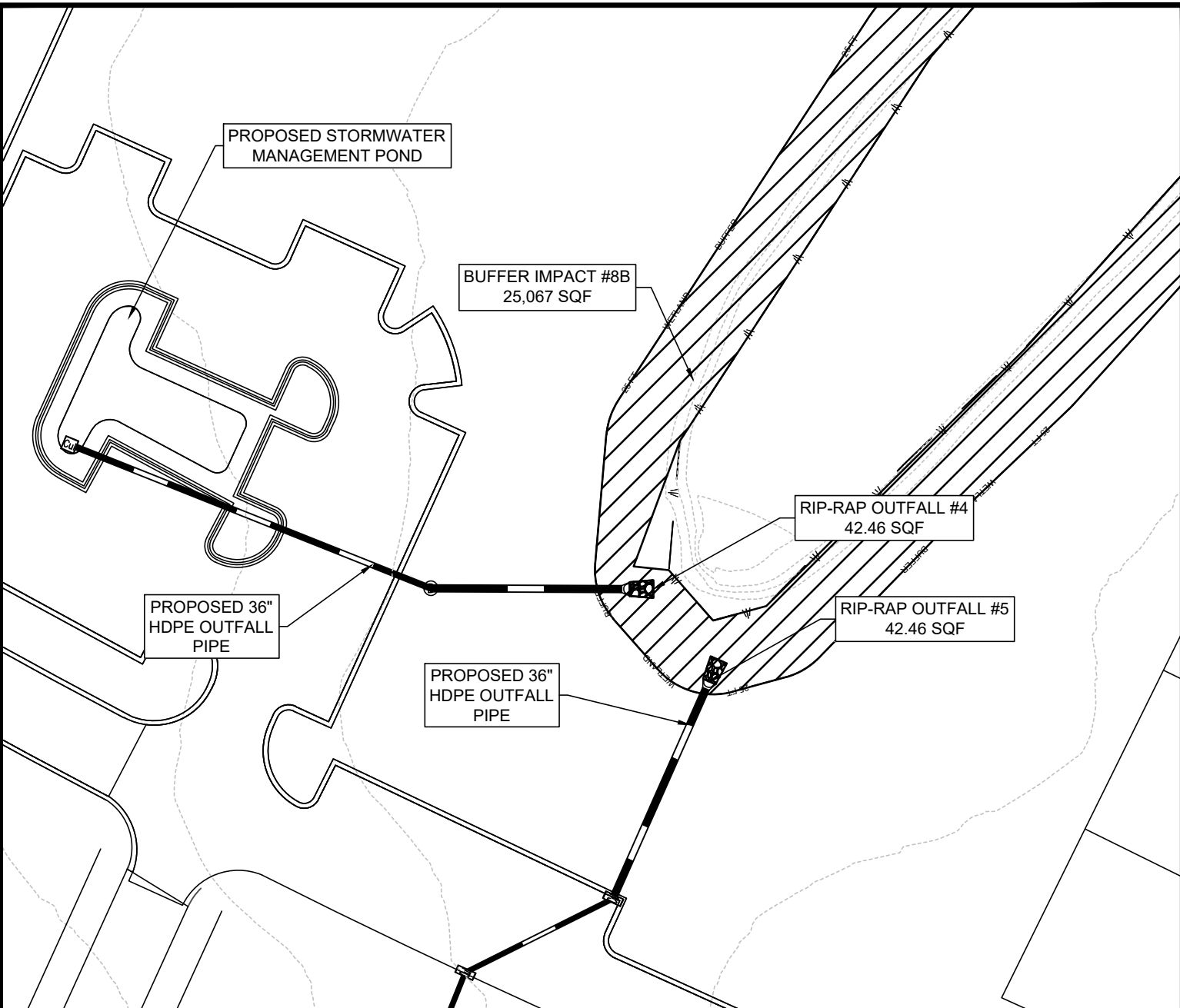

LEGEND:

- = NONTIDAL WETLANDS
- = 25 FT WETLAND BUFFER
- = EXISTING TREELINE
- = PROPERTY LINE
- = LIMITS OF DISTURBANCE
- = WETLANDS IMPACT
- = WETLANDS BUFFER IMPACT

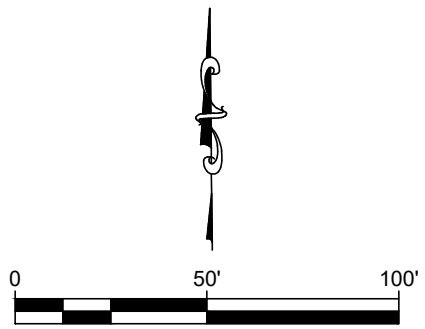

PROPOSED IMPACTS
ON THE LANDS OF:
TRAPPE EAST BUSINESS HOLDINGS TRUST
TAX MAP 55, GRID 13, PARCEL 4,14,15,17,19,44,65,83
THIRD ELECTION DISTRICT, TALBOT COUNTY, MARYLAND

DRAWN BY	KAK
SCALE	1" = 50'
DATE	04.16.21
SHEET	14 OF 22

RAUCH
inc.
engineering design & development services

office: 410.770.9081 | fax: 410.770.3667
email: design@raucheng.com | web: www.raucheng.com
Maryland Office: 106 N. Harrison St - Easton, MD 21601
Virginia Office: 8229 Boone Blvd, Suite 625 - Vienna, VA 22182

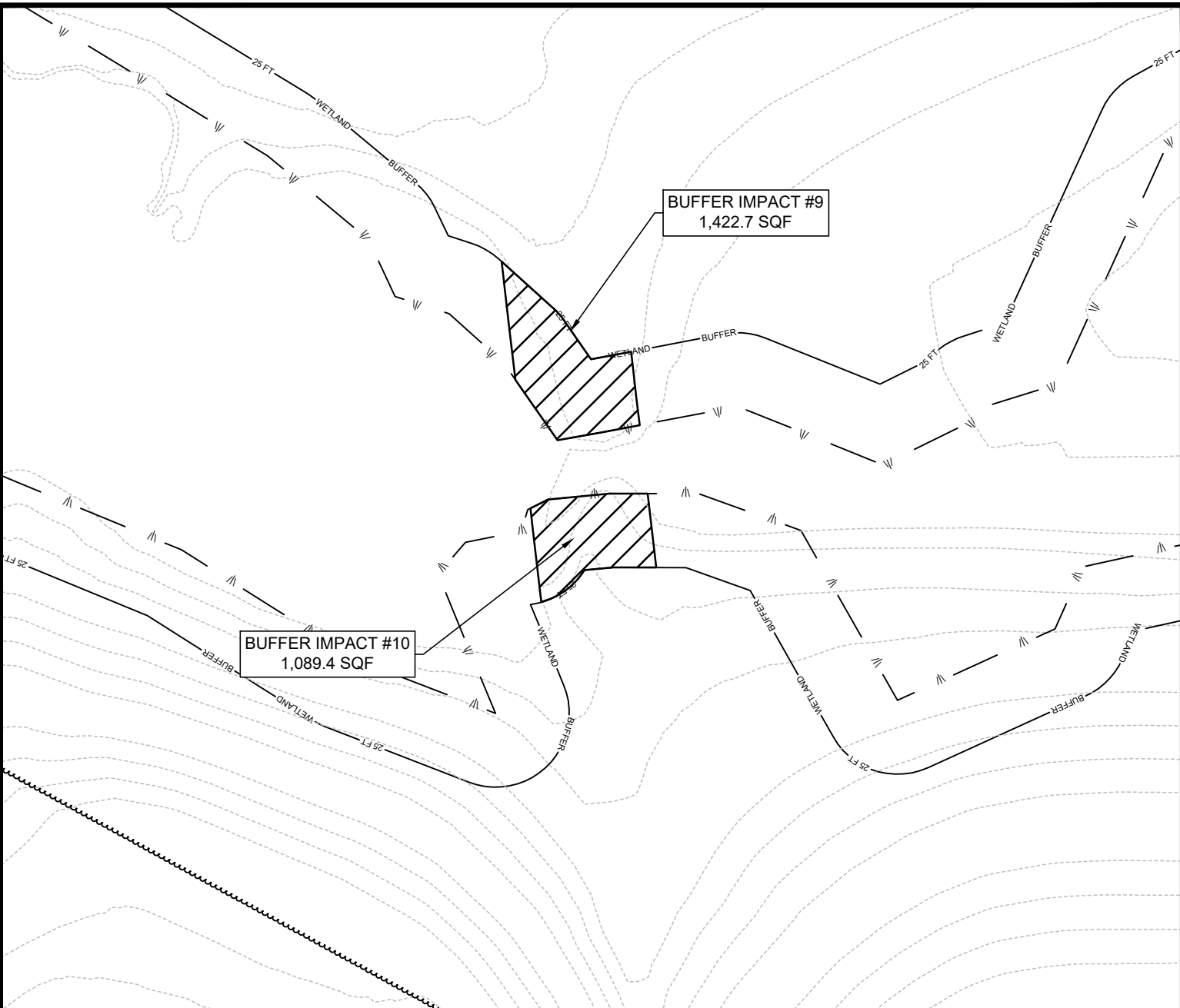

LEGEND:

- = NONTIDAL WETLANDS
- = 25 FT WETLAND BUFFER
- = EXISTING TREELINE
- = PROPERTY LINE
- = LIMITS OF DISTURBANCE
- = WETLANDS IMPACT
- = WETLANDS BUFFER IMPACT

***NOTE:**
 THIS IMPACT IS PLANNED AS PART OF A FUTURE PHASE. DETAILED PLANS AND REVISED IMPACTS WILL BE SUBMITTED WHEN NECESSARY

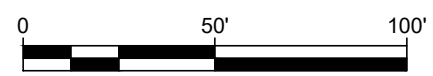

PROPOSED IMPACTS	
ON THE LANDS OF:	
TRAPPE EAST BUSINESS HOLDINGS TRUST	
TAX MAP 55, GRID 13, PARCEL 4,14,15,17,19,44,65,83	
THIRD ELECTION DISTRICT, TALBOT COUNTY, MARYLAND	

DRAWN BY	KAK
SCALE	1" = 50'
DATE	04.16.21
SHEET	15 OF 22

RAUCH
 inc.
 engineering design &
 development services

office: 410.770.9081 | fax: 410.770.3667
 email: design@raucheng.com | web: www.raucheng.com
 Maryland Office: 106 N. Harrison St - Easton, MD 21601
 Virginia Office: 8229 Boone Blvd, Suite 625 - Vienna, VA 22182

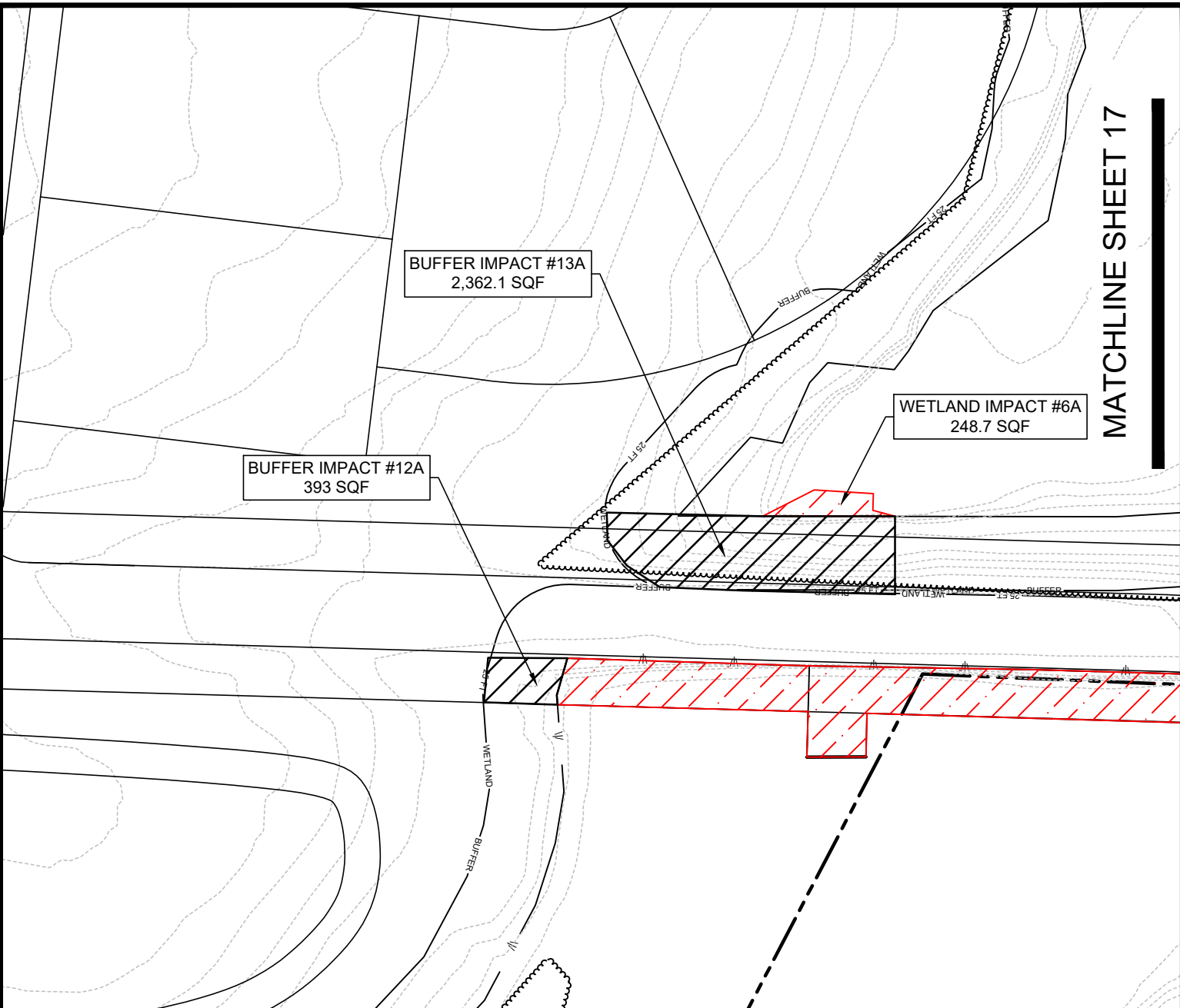

LEGEND:

- = NONTIDAL WETLANDS
- = 25 FT WETLAND BUFFER
- = EXISTING TREELINE
- = PROPERTY LINE
- = LIMITS OF DISTURBANCE
- = WETLANDS IMPACT
- = WETLANDS BUFFER IMPACT

*NOTE:

THIS IMPACT IS PLANNED AS PART OF A FUTURE PHASE. DETAILED PLANS AND REVISED IMPACTS WILL BE SUBMITTED WHEN NECESSARY

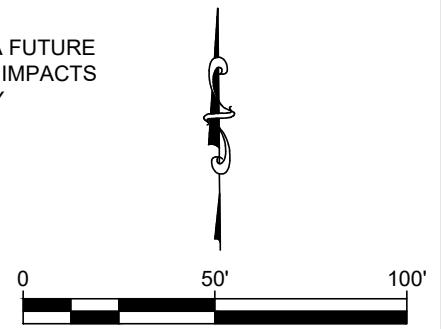

PROPOSED IMPACTS

ON THE LANDS OF:

TRAPPE EAST BUSINESS HOLDINGS TRUST

TAX MAP 55, GRID 13, PARCEL 4,14,15,17,19,44,65,83

THIRD ELECTION DISTRICT, TALBOT COUNTY, MARYLAND

DRAWN BY KAK

SCALE 1" = 50'

DATE 04.16.21

SHEET 16 OF 22

RAUCH
inc.

engineering design &
development services

office: 410.770.9081 | fax: 410.770.3667
email: design@raucheng.com | web: www.raucheng.com
Maryland Office: 106 N. Harrison St - Easton, MD 21601
Virginia Office: 8229 Boone Blvd, Suite 625 - Vienna, VA 22182

MATCHLINE SHEET 16

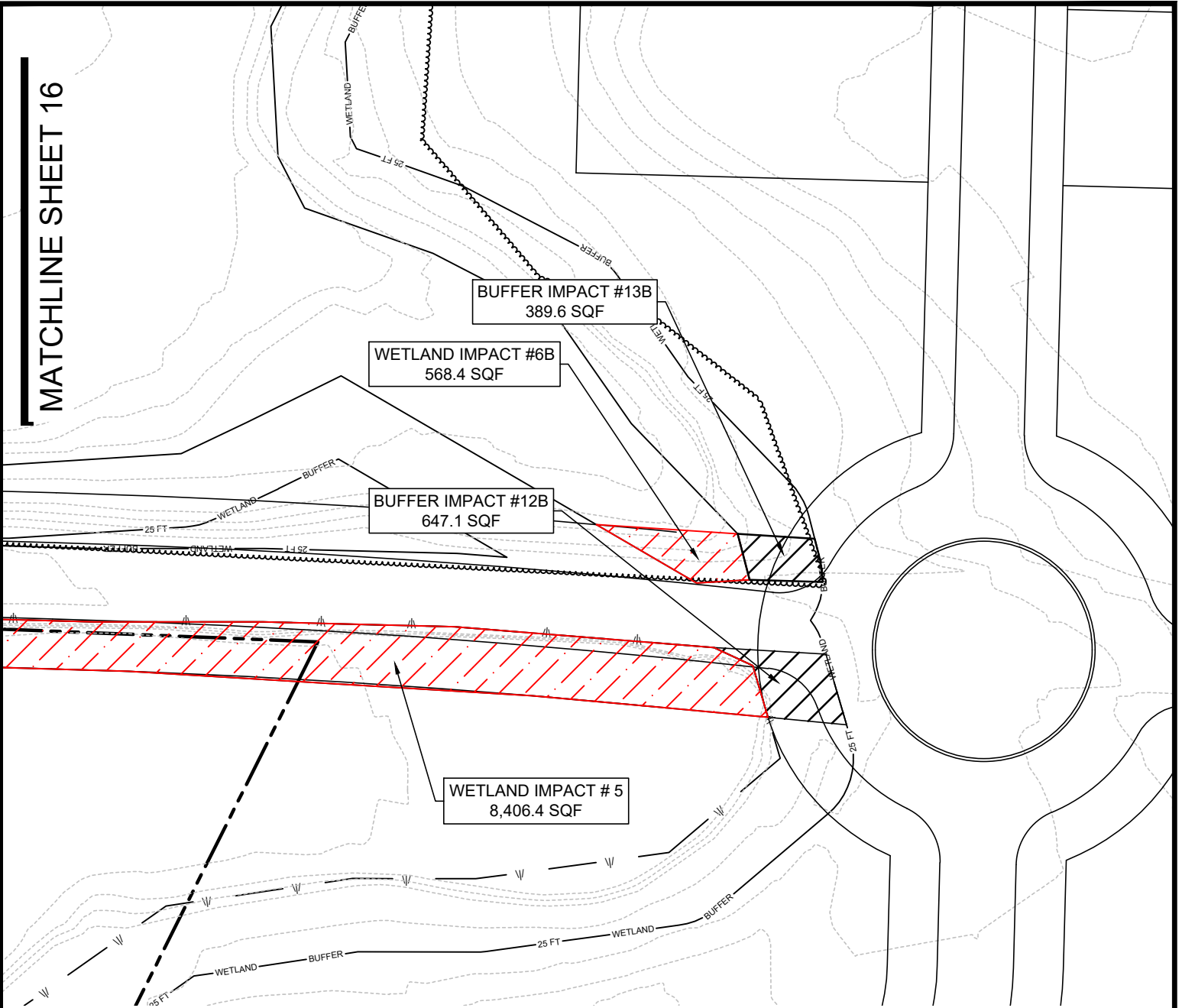

LEGEND:

- = NONTIDAL WETLANDS
- = 25 FT WETLAND BUFFER
- = EXISTING TREELINE
- = PROPERTY LINE
- = LOD = LIMITS OF DISTURBANCE
- = WETLANDS IMPACT
- = WETLANDS BUFFER IMPACT

***NOTE:**

THIS IMPACT IS PLANNED AS PART OF A FUTURE PHASE. DETAILED PLANS AND REVISED IMPACTS WILL BE SUBMITTED WHEN NECESSARY



PROPOSED IMPACTS

ON THE LANDS OF:

TRAPPE EAST BUSINESS HOLDINGS TRUST

TAX MAP 55, GRID 13, PARCEL 4,14,15,17,19,44,65,83

THIRD ELECTION DISTRICT, TALBOT COUNTY, MARYLAND

DRAWN BY KAK

SCALE 1" = 50'

DATE 04.16.21

SHEET 17 OF 22

RAUCH
inc.

engineering design &
development services

office: 410.770.9081 | fax: 410.770.3667
email: design@raucheng.com | web: www.raucheng.com
Maryland Office: 106 N. Harrison St - Easton, MD 21601
Virginia Office: 8229 Boone Blvd, Suite 625 - Vienna, VA 22182

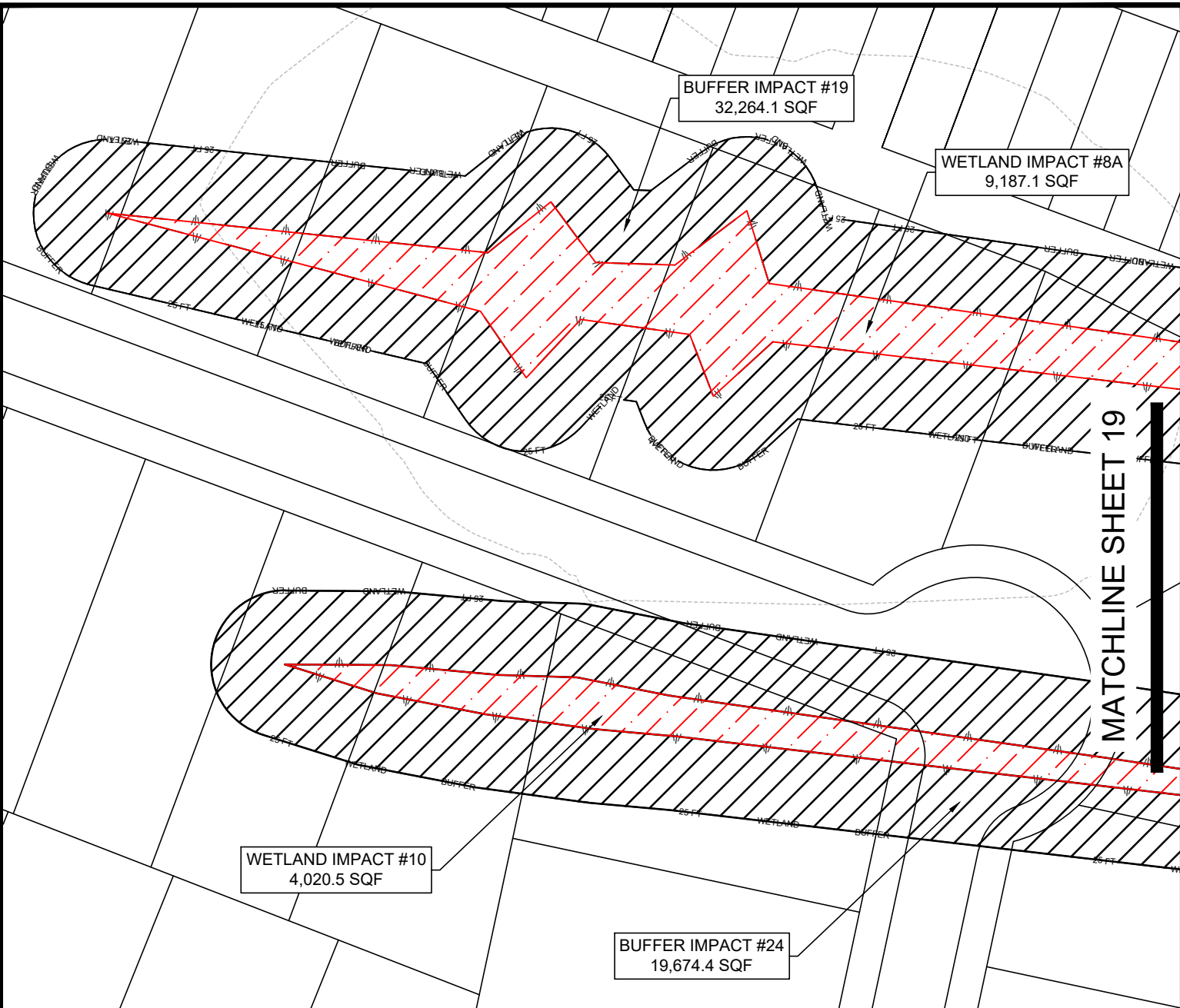

LEGEND:

- = NONTIDAL WETLANDS
- = 25 FT WETLAND BUFFER
- = EXISTING TREELINE
- = PROPERTY LINE
- = LIMITS OF DISTURBANCE
- = WETLANDS IMPACT
- = WETLANDS BUFFER IMPACT

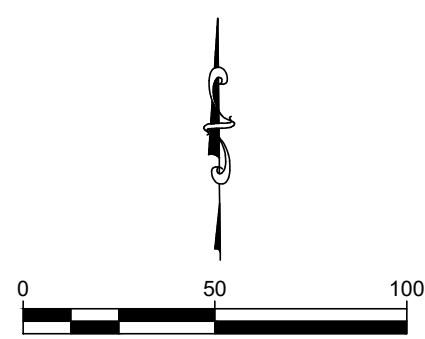

PROPOSED IMPACTS

ON THE LANDS OF:

TRAPPE EAST BUSINESS HOLDINGS TRUST

TAX MAP 55, GRID 13, PARCEL 4,14,15,17,19,44,65,83

THIRD ELECTION DISTRICT, TALBOT COUNTY, MARYLAND

DRAWN BY KAK

SCALE 1" = 50'

DATE 04.16.21

SHEET 18 OF 22

RAUCH
inc.

engineering design &
development services

office: 410.770.9081 | fax: 410.770.3667
email: design@raucheng.com | web: www.raucheng.com
Maryland Office: 106 N. Harrison St - Easton, MD 21601
Virginia Office: 8229 Boone Blvd, Suite 625 - Vienna, VA 22182

MATCHLINE SHEET 18

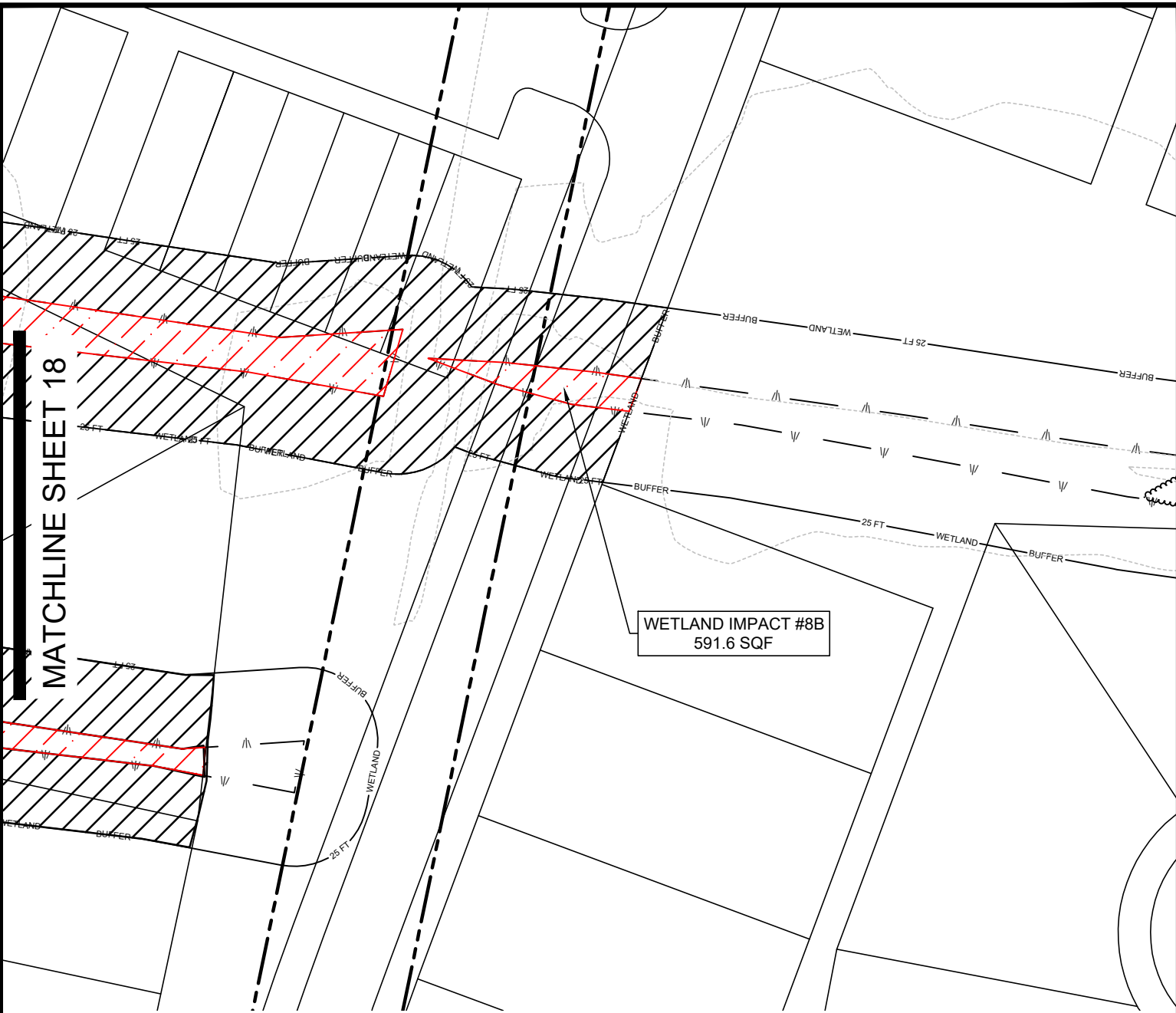

LEGEND:

- = NONTIDAL WETLANDS
- = 25 FT WETLAND BUFFER
- = EXISTING TREELINE
- = PROPERTY LINE
- = LIMITS OF DISTURBANCE
- = WETLANDS IMPACT
- = WETLANDS BUFFER IMPACT

PROPOSED IMPACTS

ON THE LANDS OF:

TRAPPE EAST BUSINESS HOLDINGS TRUST

TAX MAP 55, GRID 13, PARCEL 4,14,15,17,19,44,65,83

THIRD ELECTION DISTRICT, TALBOT COUNTY, MARYLAND

DRAWN BY KAK

SCALE 1" = 50'

DATE 04.16.21

SHEET 19 OF 22



RAUCH
inc.

engineering design &
development services

office: 410.770.9081 | fax: 410.770.3667
email: design@raucheng.com | web: www.raucheng.com
Maryland Office: 106 N. Harrison St - Easton, MD 21601
Virginia Office: 8229 Boone Blvd, Suite 625 - Vienna, VA 22182

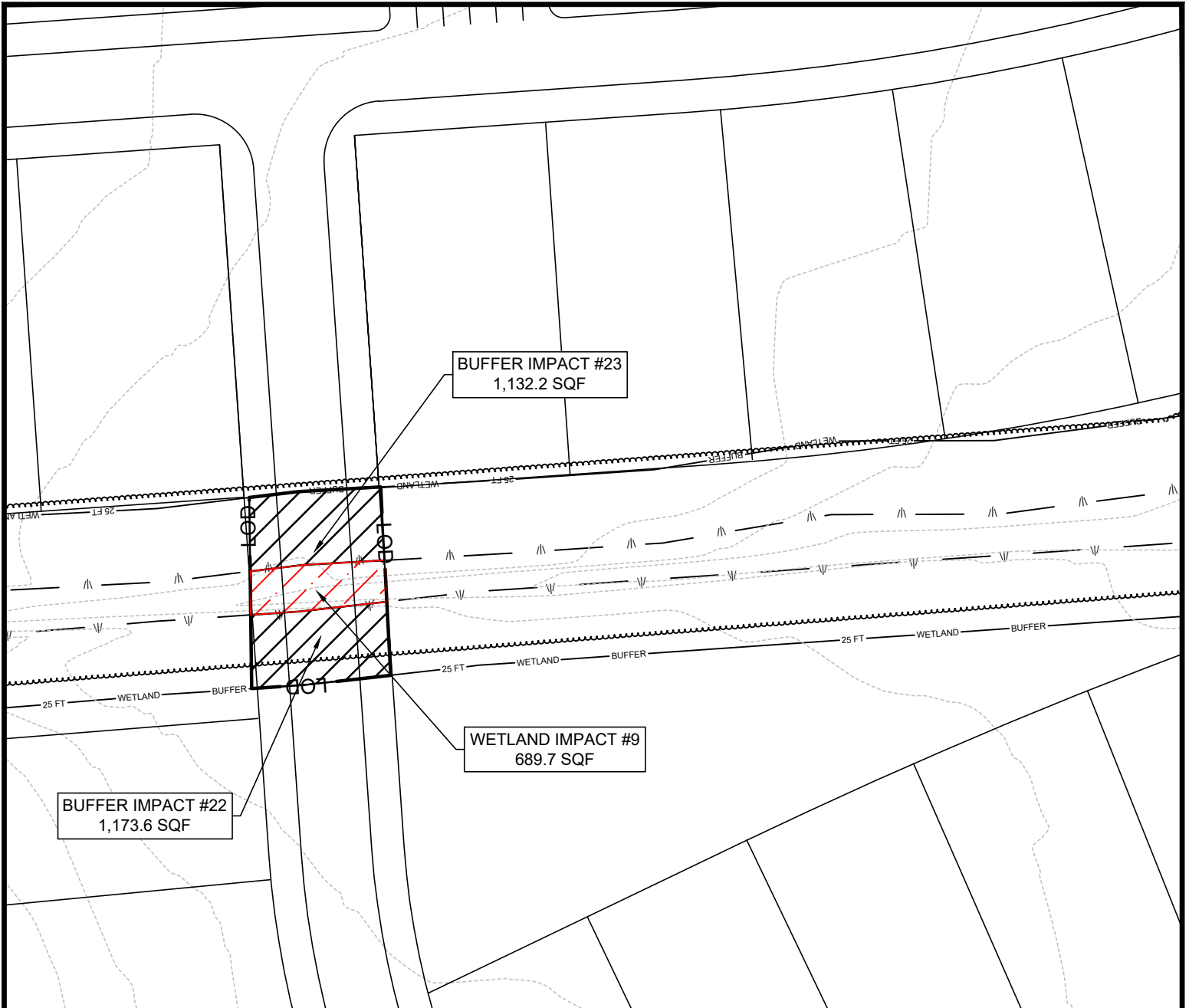

BUFFER IMPACT #23
1,132.2 SQF

WETLAND IMPACT #9
689.7 SQF

BUFFER IMPACT #22
1,173.6 SQF

LEGEND:

- = NONTIDAL WETLANDS
- = 25 FT WETLAND BUFFER
- = EXISTING TREELINE
- = PROPERTY LINE
- = LIMITS OF DISTURBANCE
- = WETLANDS IMPACT
- = WETLANDS BUFFER IMPACT

*NOTE:
THIS IMPACT IS PLANNED AS PART OF A FUTURE PHASE. DETAILED PLANS AND REVISED IMPACTS WILL BE SUBMITTED WHEN NECESSARY



PROPOSED IMPACTS	
ON THE LANDS OF:	
TRAPPE EAST BUSINESS HOLDINGS TRUST	
TAX MAP 55, GRID 13, PARCEL 4,14,15,17,19,44,65,83	
THIRD ELECTION DISTRICT, TALBOT COUNTY, MARYLAND	

DRAWN BY	KAK
SCALE	1" = 50'
DATE	04.16.21
SHEET	20 OF 22

RAUCH
inc.

engineering design &
development services

office: 410.770.9081 | fax: 410.770.3667
email: design@raucheng.com | web: www.raucheng.com
Maryland Office: 106 N. Harrison St - Easton, MD 21601
Virginia Office: 8229 Boone Blvd, Suite 625 - Vienna, VA 22182

WETLAND IMPACT SUMMARY

<u>Wetland Impact #</u>	<u>Wetland Impact Area (sf)</u>	<u>Page #</u>
DELETED	-	-
2	835.3	11
DELETED	-	-
DELETED	-	-
5	8,406.4	17
6A	248.7	16
6B	568.4	17
DELETED	-	-
8A	9,187.1	18
8B	591.6	19
9	689.8	20
10	4,020.5	18
11	1,595.1	17
TOTAL:	26,142.9	

IMPACT SUMMARY

ON THE LANDS OF:

TRAPPE EAST BUSINESS HOLDINGS TRUST

TAX MAP 55, GRID 13, PARCEL 4,14,15,17,19,44,65,83

THIRD ELECTION DISTRICT, TALBOT COUNTY, MARYLAND

DRAWN BY KAK

SCALE NTS

DATE 04.16.21

SHEET 21 OF 22

RAUCH

inc.

engineering design &
development services

office: 410.770.9081 | fax: 410.770.3667
email: design@raucheng.com | web: www.raucheng.com
Maryland Office: 106 N. Harrison St - Easton, MD 21601
Virginia Office: 8229 Boone Blvd, Suite 625 - Vienna, VA 22182

WETLAND BUFFER IMPACT SUMMARY

<u>Buffer Impact #</u>	<u>Buffer Impact Area (sf)</u>	<u>Page #</u>
1	-	-
2A	2,263.1	9
2B	5,055.9	9
2C	4,004.3	10
2D	1,916.7	10
3	615.1	11
4	432.9	11
8A	2,732.6	13
8B	25,067.0	14
8C	1,796.5	12
9	1,422.7	15
10	1,089.4	15
12A	393.0	16
12B	647.1	17
13A	2,362.1	16
13B	568.4	17
18	6,503.6	17
19	32,264.1	18
22	1,173.6	20
23	1,132.2	20
24	19,674.4	18
TOTAL:		111,114.7

IMPACT SUMMARY

ON THE LANDS OF:

TRAPPE EAST BUSINESS HOLDINGS TRUST

TAX MAP 55, GRID 13, PARCEL 4,14,15,17,19,44,65,83

THIRD ELECTION DISTRICT, TALBOT COUNTY, MARYLAND

DRAWN BY KAK

SCALE 1" = 50'

DATE 04.16.21

SHEET 22 OF 22

RAUCH

inc.

engineering design &
development services

office: 410.770.9081 | fax: 410.770.3667
email: design@raucheng.com | web: www.raucheng.com
Maryland Office: 106 N. Harrison St - Easton, MD 21601
Virginia Office: 8229 Boone Blvd, Suite 625 - Vienna, VA 22182